

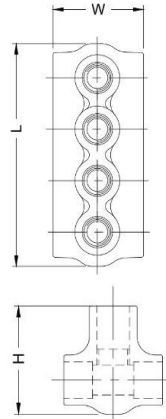

Morris CAT#: 97314-97428
Clear Insulated Dual Side Entry



Features:

- Clear Insulation
- 6061-T6 Aluminum
- Insulated with Rugged High-Dielectric Plastisol Dipped Coating
- Pre-filled with Oxide Inhibitor
- Easy Re-Entry for Changes, Inspection or Troubleshooting
- Plugs Marked with Connector Max Wire Size for Easy ID
- CU9AL Dual Rated for use with Copper and/or Aluminum Wire
- One Wire Per Terminal
- Temperature Range of -49°F to 194°F (-45° to 90°C)
- 600 Volt
- Rated For Use with 90°C Cables
- ANSI C119.4 & UL 486A & 486B Listed

DIMENSIONS = INCHES

CAT. NO.	NO. OF PORTS	WIRE RANGE	ALLEN HEX	LENGTH	WIDTH	HEIGHT	BOX QTY
97314	3			1.50			6
97316	4			1.92			6
97320	6	4-14	SLOTTED	2.75	1.21	1.45	4
97322	8			3.59			3
97333	3			1.80			6
97334	4			2.02			6
97336	6	2-14	SLOTTED	2.85	1.21	1.45	4
97338	8			3.69			3
97354	3			1.90			8
97356	4	2/0-14	3/16	2.49	1.80	1.85	6
97360	6			3.67			4
97362	8			4.85			3
97373	3			2.10			6
97374	4	3/0-14	1/4	2.87	2.09	1.99	6
97376	6			4.41			3
97378	8			5.96			3
97394	3			2.40			6
97396	4	250-6	5/16	3.29			4
97400	6			5.06	2.40	2.49	3
97402	8			6.83			3
97414	3			2.80			6
97416	4	350-6	5/16	3.85	2.75	2.64	4
97420	6			5.95			3
97422	8			8.06			3
97434	3			3.18			4
97436	4	500-4	5/16	4.95	2.97	3.03	4
97440	6			6.70			2
97442	8			9.05			2
97539	3			3.40			4
97540	4	600-250	5/16	4.89	3.25	3.11	4
97541	6			7.23			2
97542	8			9.78			2
97425	3			3.80			4
97426	4	750-250	3/8	5.03	3.85	3.60	4
97427	6			7.88			4
97428	8			10.73			2



Morris CAT#: 97324-97511
Clear Insulated Connectors - Single Side Entry

Strip Length

CONNECTOR SIZE	STRIP LENGTH IN inch		BOLT DIA FOR MOUNTING
750 MCM	2		5/16
500 MCM	1-1/2		5/16
350 MCM	1-1/2		5/16
250 MCM	1		5/16
3/0 AWG	1		1/4
1/0 AWG	1		1/4
1 AWG	1		1/4
# 4 AWG	1		1/4

TORQUE Values

WIRE SIZE	CONNECTOR SIZE										
	750	600	500	350	250	3/0	2/0	1/0	1	#2	#4
TORQUE VALUE IN/LBS											
600-750	442										
600	442	398	310								
500	442	398	310								
400	310	398	310								
350	310	398	310	221							
250	310	398	310	221	149						
4/0			310	221	149						
3/0			310	221	149	100					
2/0			310	221	149	100	89				
1/0			310	221	149	100	89	89			
#3 - # 1			310	221	149	100	89	89	89	80	
#4 - # 6			310	221	149	100	89	89	89	80	35
# 8							89	89	89	80	35
# 10 - # 14							89	89	89	80	35

Note : Not recommended for fine Stranded Flexible Wire .