

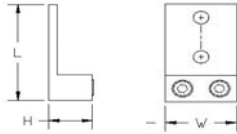

Catalog Number See Table
UPC Number
Description Two Conductor Two Hole Aluminum Mechanical Lug



- Features**
- Manufactured from High Strength High Conductivity Aluminum Alloy
 - Electro-Tin Plated
 - CU-AL Dual rated for AL/AL, AL/CU, CU/CU Applications
 - Two Conductor Two Hole Configuration

General
Conductor Size: See Table
Material: 6061-T6 Aluminum Alloy
Finish: Electro-Tin Plating
Screw Type: Hex Head
Wire Range: 300 Thru 1000 MCM

Dimension Information
 See Table

Specifications
Temperature Rating 90° C
Voltage Rating 600
Flammability Rating N/A
Amp Rating To Conductor

Packaging
Box Qty See Table

Certifications
 UL UL 486B UL41968 CU9AL Dual Rated
 CSA LR 27194
 RoHS Yes

Cat No.	AWG	Fig.	Wire Range	Box Qty	L	W	H	Bolt
90841	300	6	300MCM - 6SOL	3	4	1.95	1.12	0.56
90842	350	6	350MCM - 6SOL	3	4.25	1.92	1.18	0.56
90844	600	6	600MCM - 2SOL	3	4.46	2.4	1.56	0.56
90845	750	6	750MCM - 1/0STR	3	4.72	3.5	1.81	0.56
90847	1000	6	1000MCM - 500MCM	3	4.81	3.5	1.94	0.56