



**Catalog Number** 11836  
**UPC Number** 60198611836  
**Description** Nylon Insulated Pin Terminal  
 12-10 AWG



**Features**

- Manufactured from high strength copper alloy
- Electro-tin plated for corrosion resistance
- Expanded insulation eliminates strand “Hang Up”, provides strain relief & excellent High Temp, UV & chemical resistance
- Wire range stamped on the surface for easy interpretation
- Brazed seam prevents splitting under maximum pressure
- Serrated barrel provides excellent contact & mechanical pull-out force resistance characteristics
- Excellent for terminal block applications

**General**

**Insulation Type** Nylon  
**Material** Copper Tubular/Copper Plate  
**Finish** Electro-Tin Plated  
**Color** Yellow  
**Wire Range** 12-10  
**Stud Size** N/A

**Dimension Information**

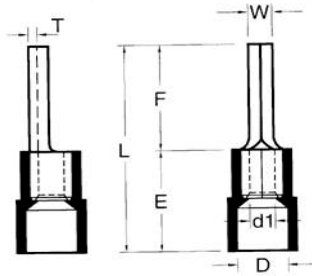

**L Inches (mm)** 1.063  
**D Inches (mm)** 0.252  
**D1 Inches (mm)** 0.134  
**E Inches (mm)** 0.512  
**F Inches (mm)** 0.551  
**W Inches (mm)** 0.11  
**T Inches (mm)** 0.039

**Specifications**

**Temperature Rating** 105°C  
**Voltage Rating** 600 V  
**Flammability Rating** UL 94 V-0  
**Amp Rating** 12 AWG 35 Amps  
 10 AWG 50 Amps

**Packaging**

**Bag Qty** 100  
**Master Bag Qty** 1000

**Certifications**

**UL** Yes  
**cUL** Yes  
**RoHS** Yes

Morris Products 53 Carey Road, Queensbury, NY 12804  
[www.morrisproducts.com](http://www.morrisproducts.com)

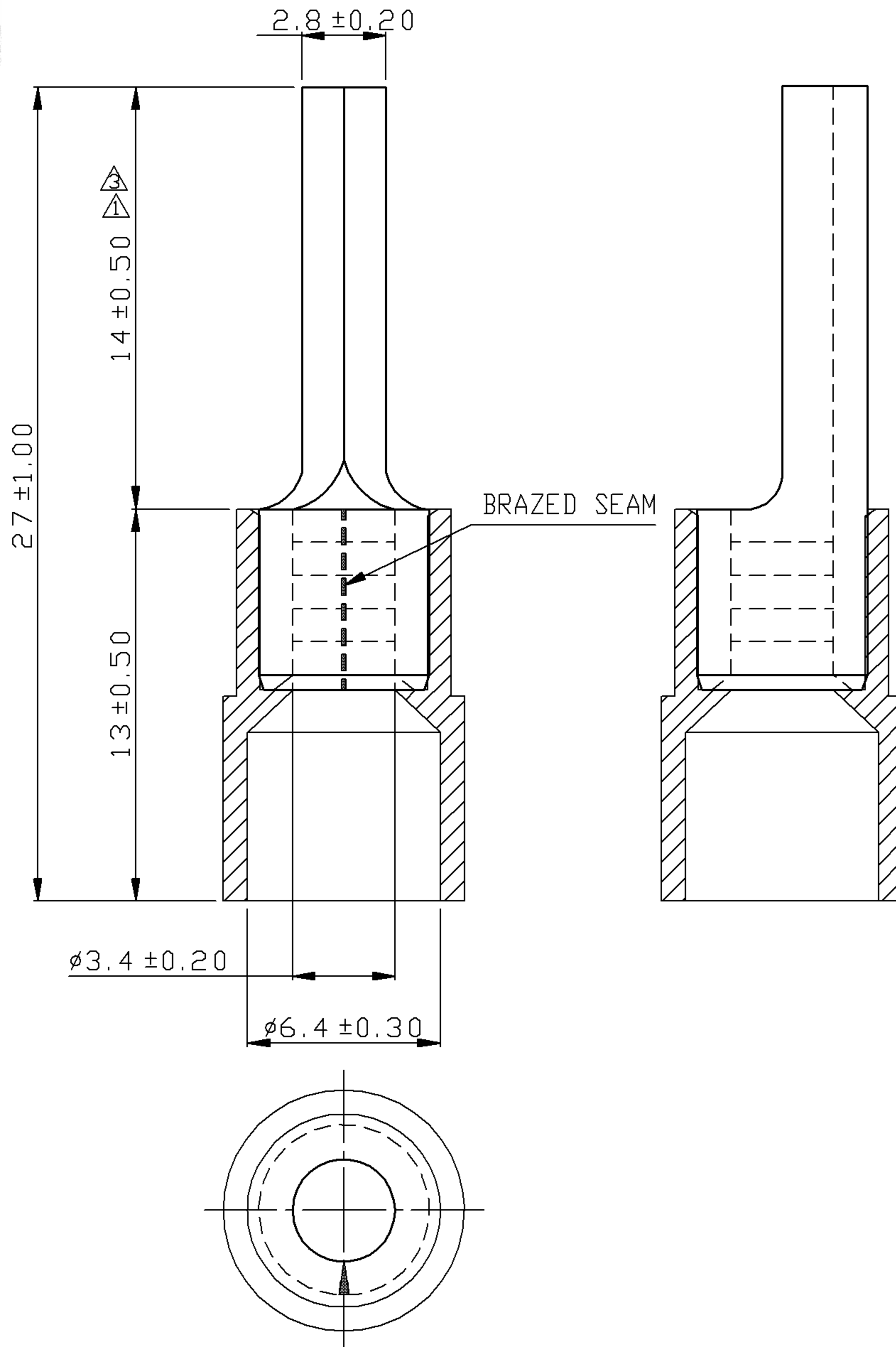

REV	DESCRIPTION	DATE
△	RDK-97127	2008/11/24
△	RDK-98020	2009/06/11
△	RDC-98308	2009/06/11

NOTE:

- MAXIMUM ELECTRIC CURRENT : 

A.W.G.	12	10	
AMP.	35	50	
- MAXIMUM ELECTRICAL RATING : 105°C 600 VOLTS MAX.
- INSULATION MATERIAL : NYLON
- INSULATION COLOR : YELLOW
- TERMINAL MATERIAL : COPPER
- WIRE RANGE : 12-10 A.W.G.( 4-6 mm<sup>2</sup>)
- TERMINALS SURFACE TREATMENT : TIN PLATED
- TERMINALS THICKNESS : 1.00 mm

△ Tolerance Unless	
□ Otherwise Specified	
0 >	mm ± ANGLE
>	mm ± 0° ° REF ±
>	mm ± ° ° ±
>	mm ± ° ° ±

NAME	NYLON-INSULATED PIN TERMINALS				UNIT	
PART NO.	11836	MATERIAL	-----	APPROVE		
NUMBER		SCALE	SHEET	PAGE	CHECKED	
DATE	2006/08/09	4/1	1-3	10F1	DRAWN	

Morris Products Inc.  
53 Carey Rd. Queensbury, NY 12804