

Installation Instructions and Templates

For Door Closer DC 1

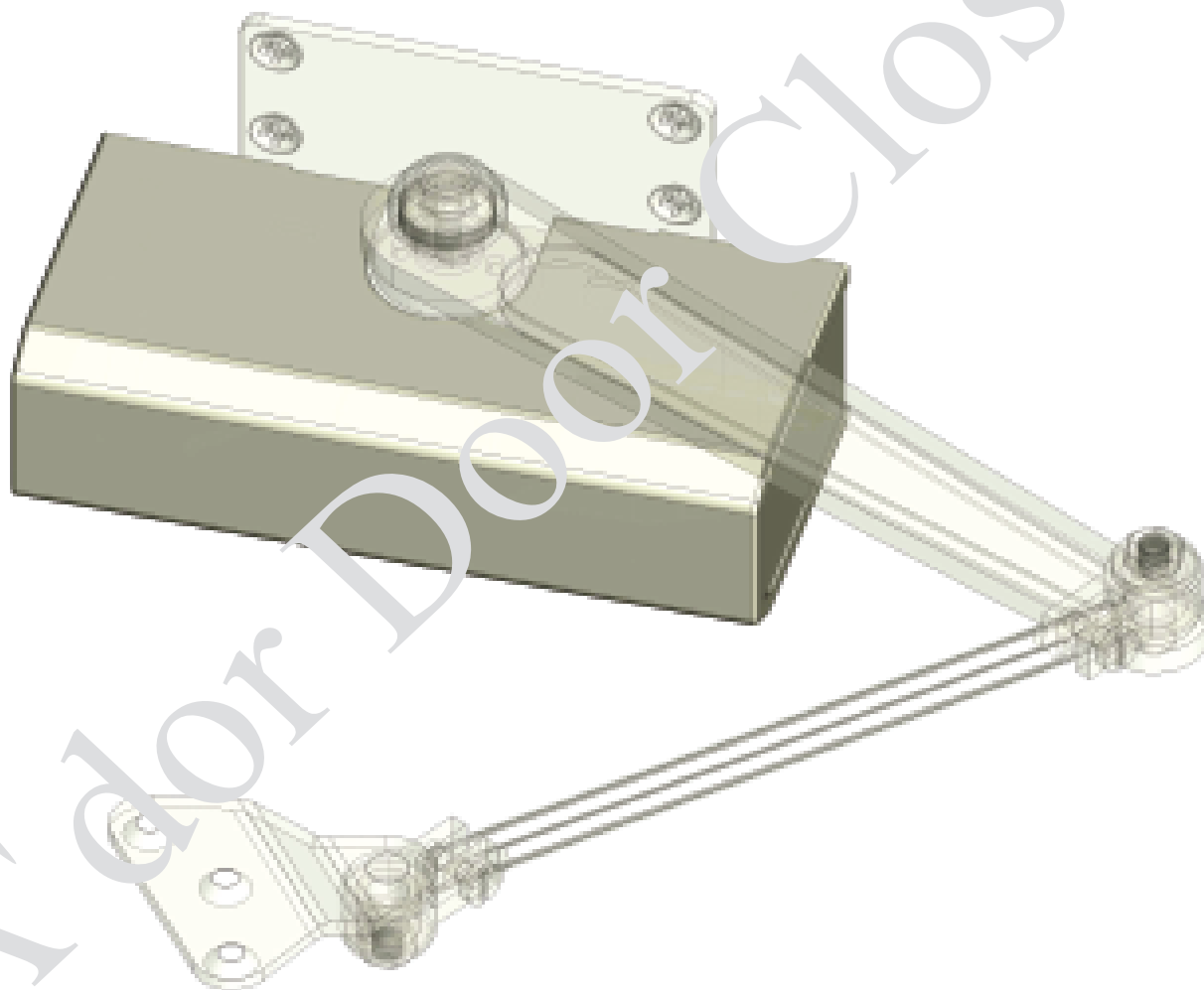

Installation Instructions and Template

Step 1. Prepare required tools:



Drill

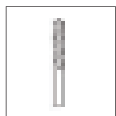

Drill bit 5/32"

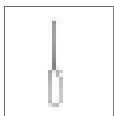

Phillips head
Screw driver



Tape

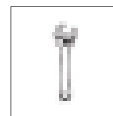

Wrench

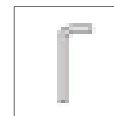

Allen wrench
(provided)



1. Place all components on soft surface to avoid scratching.
2. Do not snap the body cover ① on body ② until installation is complete.

Step 2. Check list of components provided:

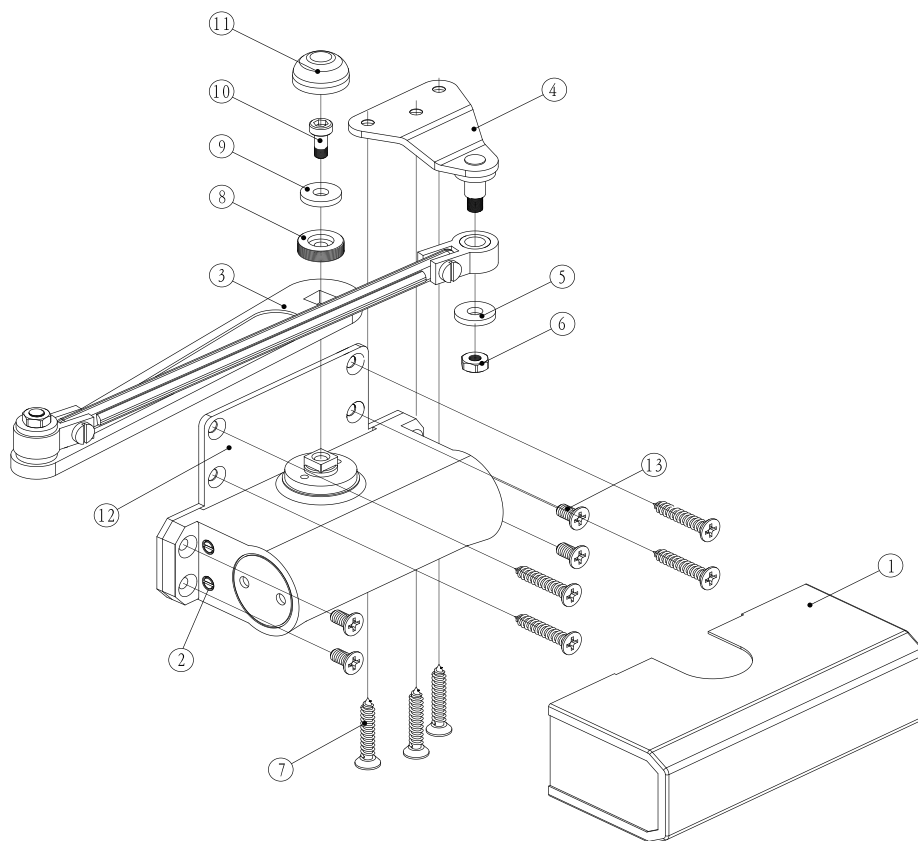

Provided components list		
<input type="checkbox"/>	①	Body cover
<input type="checkbox"/>	②	Adjusting valves
<input type="checkbox"/>	③	Arm
<input type="checkbox"/>	④	45° bracket
<input type="checkbox"/>	⑤	Washer
<input type="checkbox"/>	⑥	Nut
<input type="checkbox"/>	⑦	Screw x 7
<input type="checkbox"/>	⑧	Threaded base
<input type="checkbox"/>	⑨	Washer
<input type="checkbox"/>	⑩	Allen screw
<input type="checkbox"/>	⑪	Screw cover
<input type="checkbox"/>	⑫	Body plate
<input type="checkbox"/>	⑬	Body plate screw x 4

Step 3. Choose the correct template for your door, cut off the template, then follow the instructions on the template.

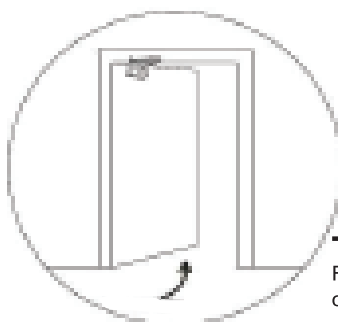

Template No.1
For left hand door (LH),
closer mounted on push side.

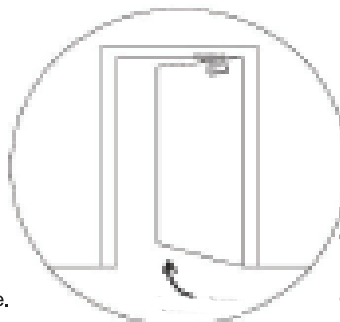

Template No. 2
For right hand door (RH),
closer mounted on push side.

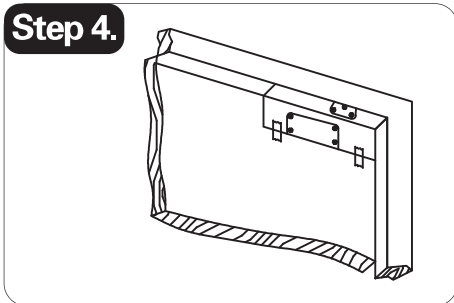

Close door, fold and tape template on top right corner of door, drill 7 holes with 5/32" drill bit and 3/4" deep.

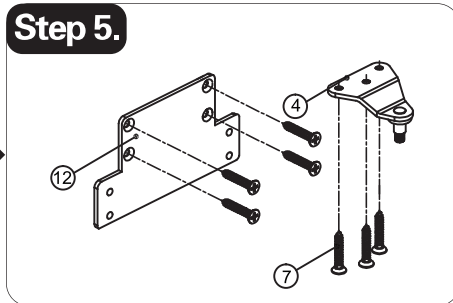

Secure 45° bracket (4) under door jamb (countersink holes face down) with screws (7). Secure body plate (12) on door (countersink holes face you) with screws (7).

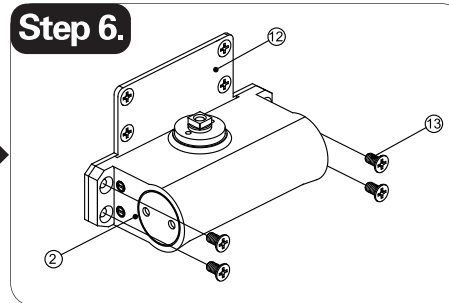

Secure closer (2) on body plate (12) with screws (13), (speed adjusting valve faces door lock).

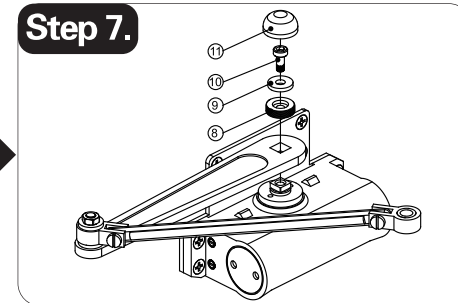

Connect body (2) and arm (3) with components (8) (9) (10) (11).

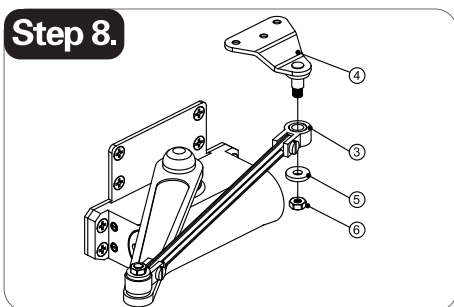

Connect arm (3) and bracket (4) with components (5) (6).

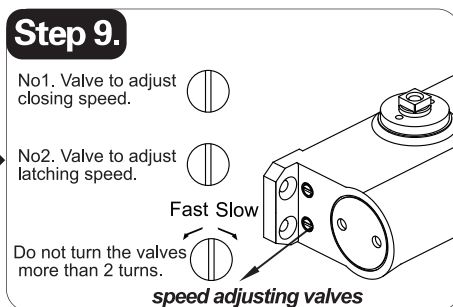

Adjust door closing/latching speed while you open and close the door until you are satisfied with the speed.

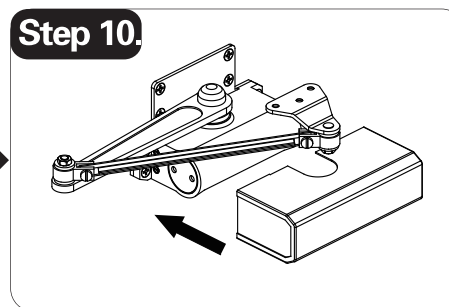

Snap body cover (1) on body (2) and installation is complete.

Note.

The door will stay open at 120° or more. To engage the automatic closing function, simply close the door less than 120°.

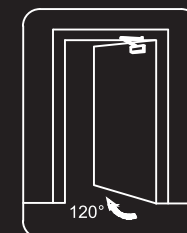

cut-off line

folding line

top jamb

cut-off line

Top right and hinge side of door.

3"(76.2mm)

3 1/2"(88.9mm)

TEMPLATE NO.2

Ador Inc.
210 Redstone Hill Rd, Bristol, CT 06010
Phone: 877.590.2367 Fax: 860.583.2371
www.adorinc.com

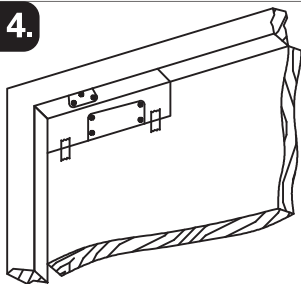
Step 4.

Close door, fold and tape template on top left corner of door, drill 7 holes with 5/32" drill bit and 3/4" deep.

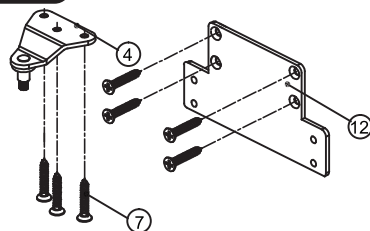
Step 5.

Secure 45° bracket (4) under door jamb (countersink holes face down) with screws (7).
Secure body plate (12) on door (countersink holes face you) with screws (7).

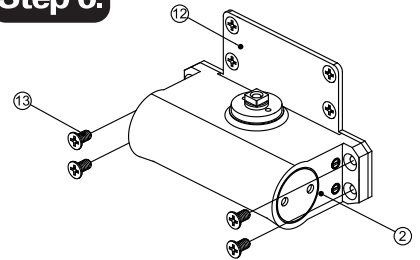
Step 6.

Secure closer (2) on body plate (12) with screws (13), (speed adjusting valve faces door lock).

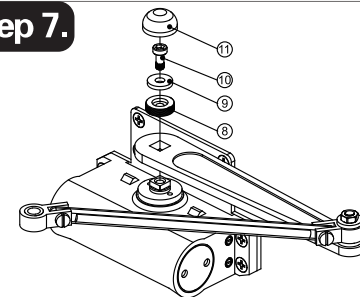
Step 7.

Connect body (2) and arm (3) with components (8) (9) (10) (11).

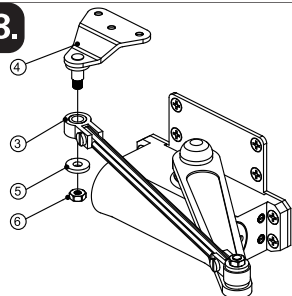
Step 8.

Connect arm (3) and bracket (4) with components (5) (6).

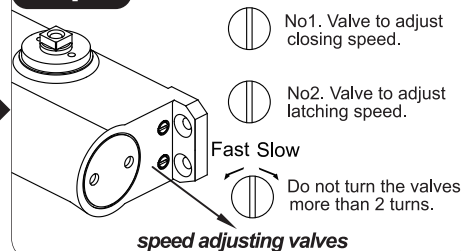
Step 9.

Adjust door closing/latching speed while you open and close the door until you are satisfied with the speed.

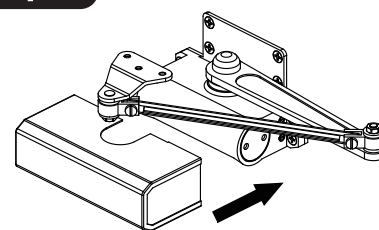
Step 10.

Snap body cover (1) on body (2) and installation is complete.

Note.

The door will stay open at 120° or more. To engage the automatic closing function, simply close the door less than 120°.

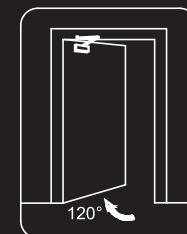

TEMPLATE NO.1

Ador Inc.
210 Redstone Hill Rd, Bristol, CT 06010
Phone: 877.590.2367 Fax: 860.583.2371
www.adorinc.com

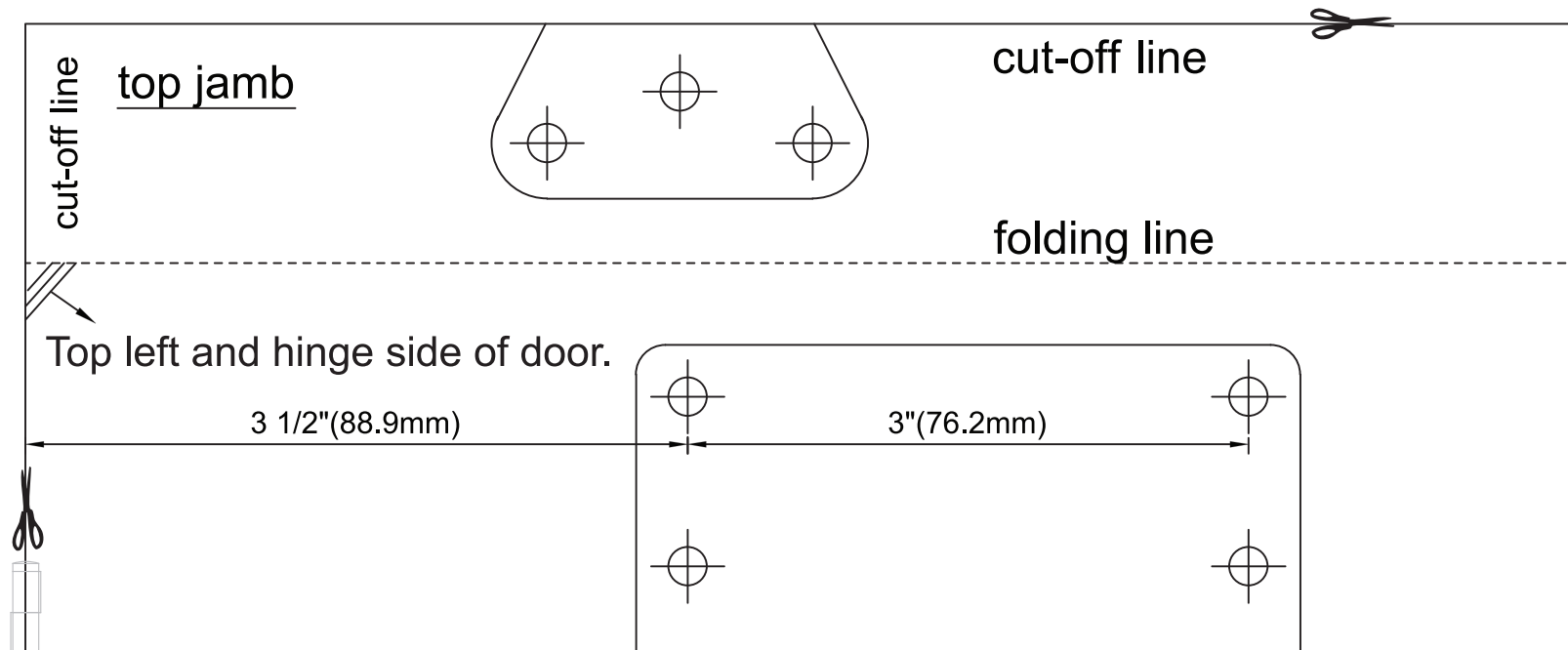

Installation Instructions and Templates

Door Closer DC1 With Optional PT16 Bracket

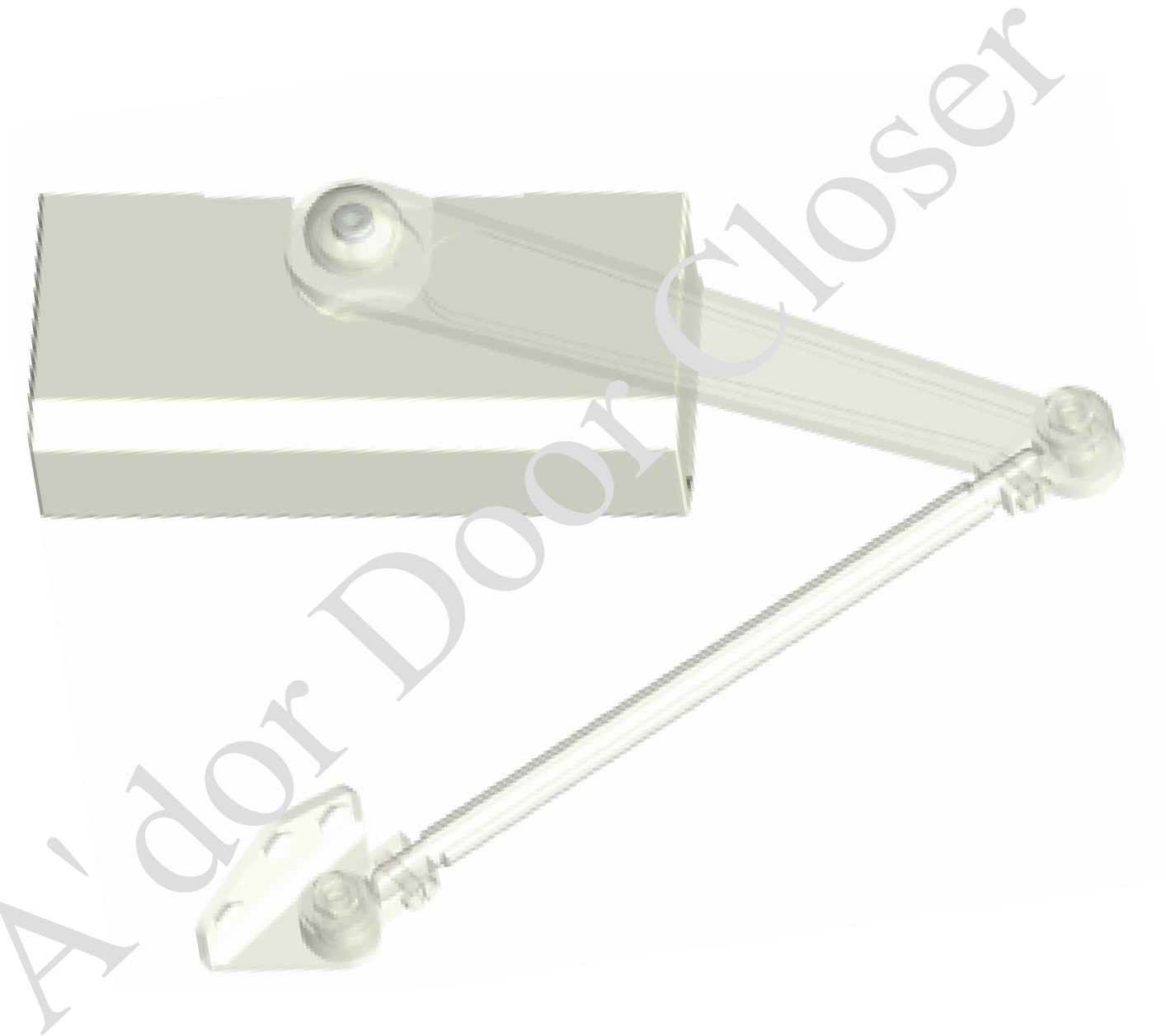

Installation Instructions and Template

Step 1. Prepare required tools:



Drill

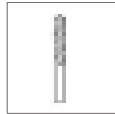

Drill bit 5/32"

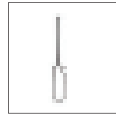

Phillips head
Screw driver



Tape



Wrench

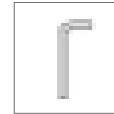

Allen wrench
(provided)



1. Place all components on soft surface to avoid scratching.
2. Do not snap the body cover ① on body ② until installation is complete.

Step 2. Check list of components provided:

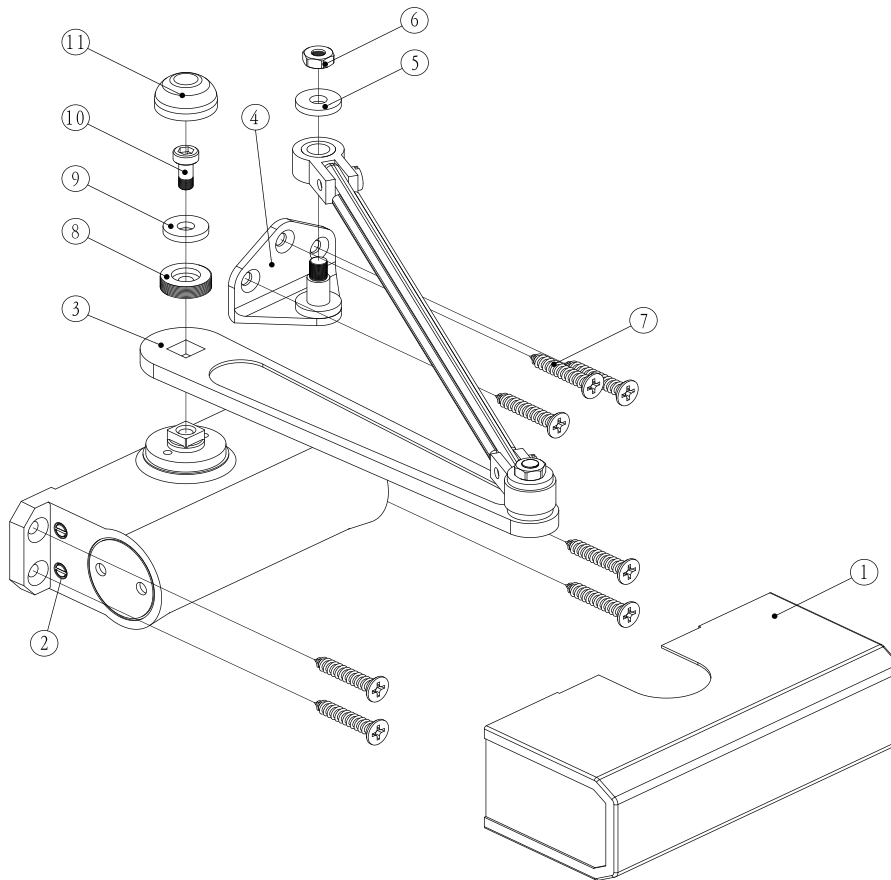

Provided components list

<input type="checkbox"/>	①	Body cover
<input type="checkbox"/>	②	Adjusting valves
<input type="checkbox"/>	③	Arm
<input type="checkbox"/>	④	45 bracket and 90 bracket
<input type="checkbox"/>	⑤	Washer
<input type="checkbox"/>	⑥	Nut
<input type="checkbox"/>	⑦	Screw x 7
<input type="checkbox"/>	⑧	Threaded base
<input type="checkbox"/>	⑨	Washer
<input type="checkbox"/>	⑩	Allen screw
<input type="checkbox"/>	⑪	Screw cover

Step 3. Choose the correct template for your door, cut off the template, then follow the instructions on the template.

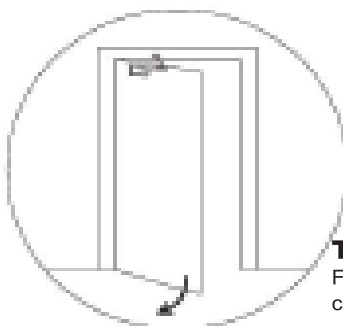

Template No.3

For left hand door (RLH),
closer mounted on pull side.

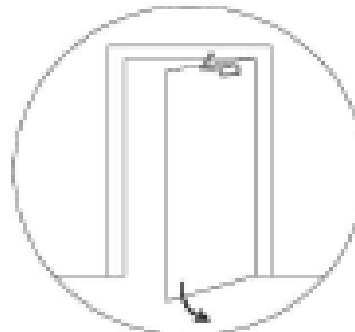

Template No. 4

For right hand door (RRH),
closer mounted on pull side.

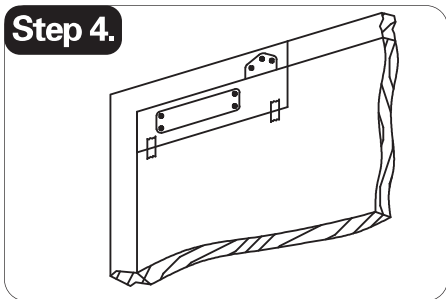

Close door, tape template on top left corner of door, drill 7 holes with 5/32" drill bit and 3/4" deep.

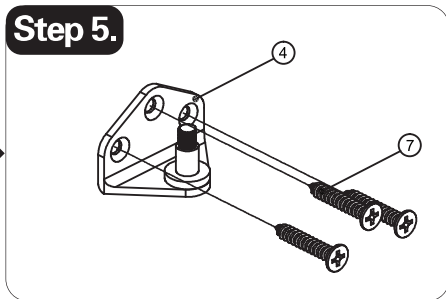

Secure 90° bracket (4) on door jamb (countersink holes face you) with screws (7).

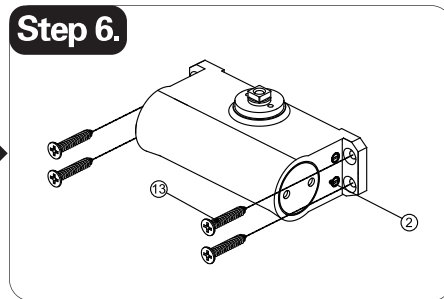

Secure closer (2) on door with screws (13) (speed adjusting valve faces door hinge).

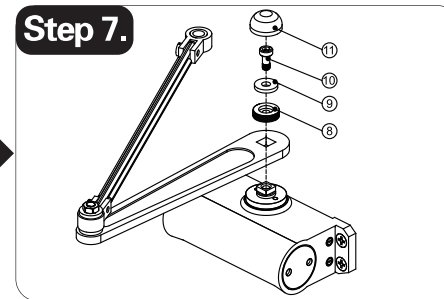

Connect body (2) and arm (3) with components (8) (9) (10) (11).

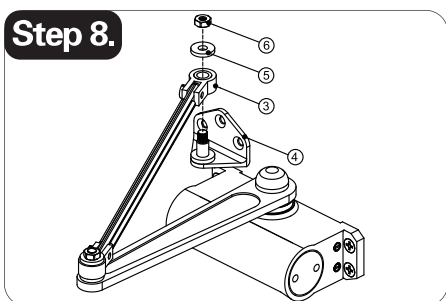

Connect arm (3) and bracket (4) with components (5) (6).

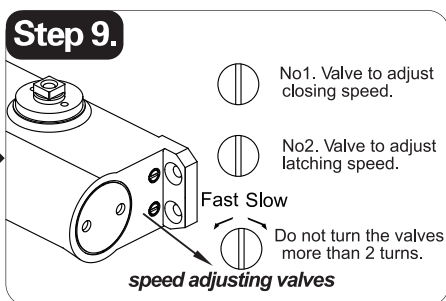

Adjust door closing/latching speed while you open and close the door until you are satisfied with the speed.

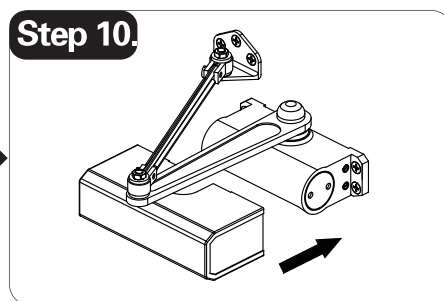

Snap body cover (1) on body (2) and installation is complete.

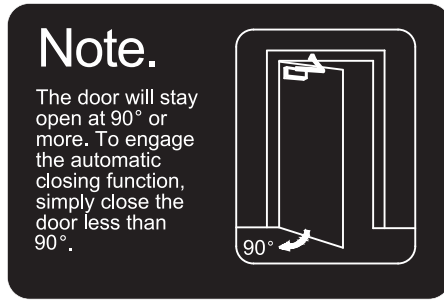

Note.

The door will stay open at 90° or more. To engage the automatic closing function, simply close the door less than 90°.

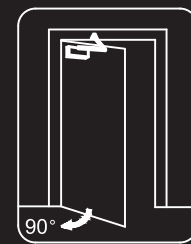

top jamb

cut-off line

cut-off line

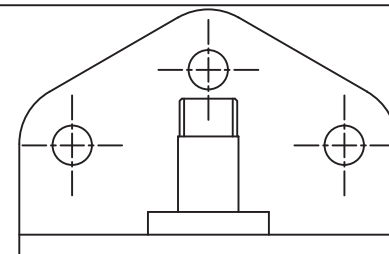

Top left and hinge side of door.

2 13/32" (61.12mm)

4 29/32" (124.62mm)

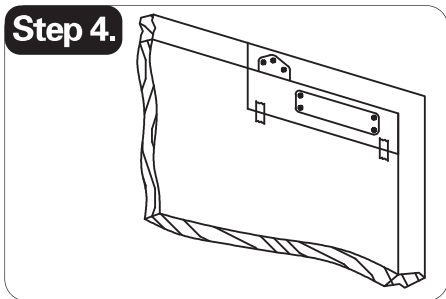

Close door, tape template on top left corner of door, drill 7 holes with 5/32" drill bit and 3/4" deep.

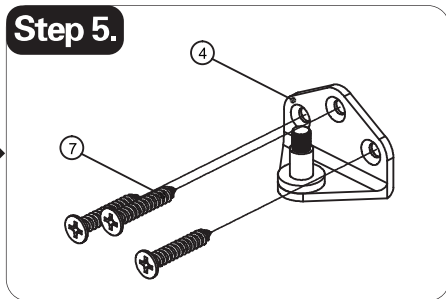

Secure 90° bracket (4) on door jamb (countersink holes face you) with screws (7).

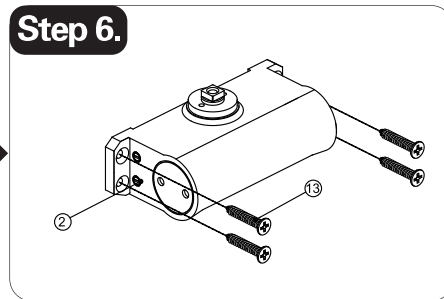

Secure closer (2) on door with screws (13) (speed adjusting valve faces door hinge).

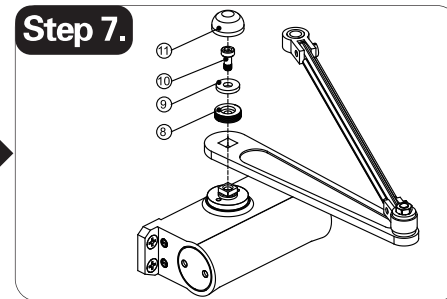

Connect body (2) and arm (3) with components (8, 9, 10, 11).

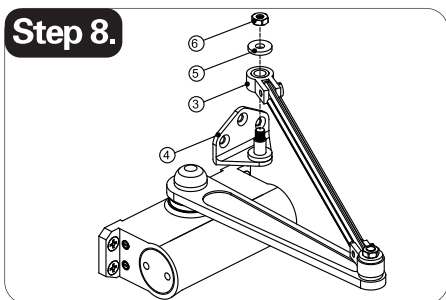

Connect arm (3) and bracket (4) with components (5, 6).

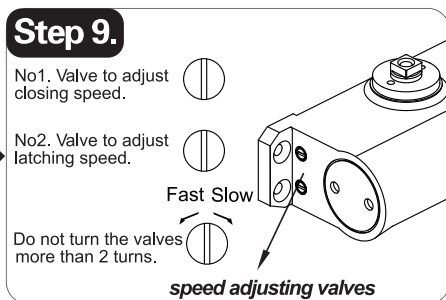

Adjust door closing/latching speed while you open and close the door until you are satisfied with the speed.

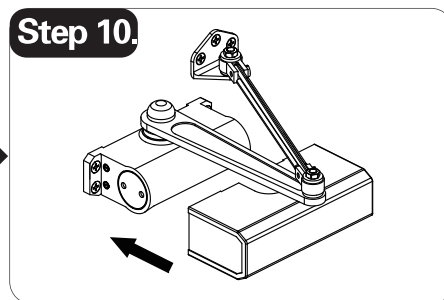

Snap body cover (1) on body (2) and installation is complete.

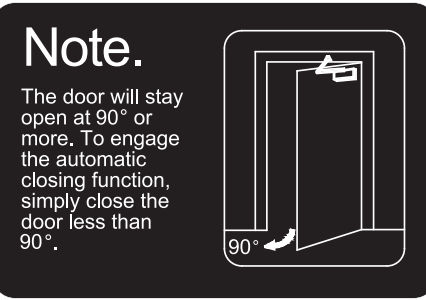

Note.

The door will stay open at 90° or more. To engage the automatic closing function, simply close the door less than 90°.

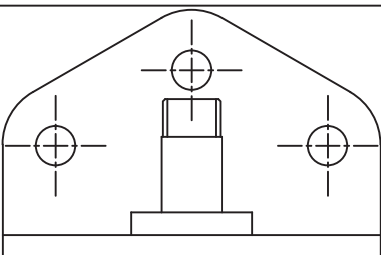
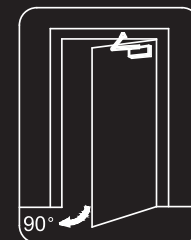

cut-off line

top jamb

cut-off line

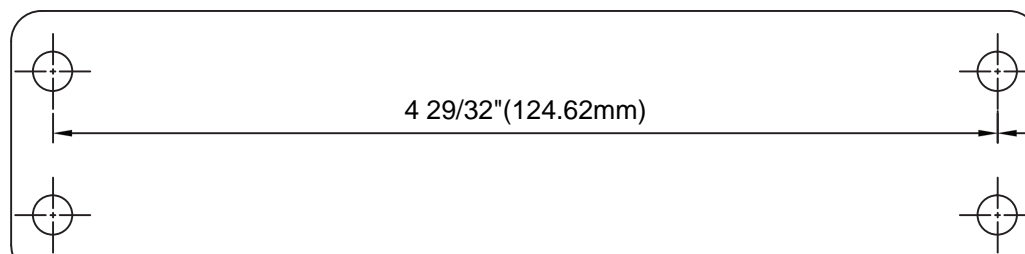

Top right and hinge side of door.

2 13/32" (61.12mm)

4 29/32" (124.62mm)