

1790 Rim touchbar device

The 1790 rim device is typically used in applications where maintenance is a concern because the rim device has fewer parts and pieces than current exit devices. The result is less maintenance and adjustment. The streamlined design has no openings for chains, reducing the risk for code infringements and offering increased building security by eliminating the possibility of tampering and forced entry through the use of coat hangers and other tools. The 1790 may also be used to retrofit a 2090 series crossbar device.



Length	Minimum door size (non-EL)	Minimum door size (EL)
30"	24"	28 1/2"
36"	30"	34 1/2"
42"	36"	40 1/2"
48"	42"	46 1/2"

- Lock/unlock capability
- ADA accessible
- Lever designs
 - Dane
 - Sutro
 - Quantum

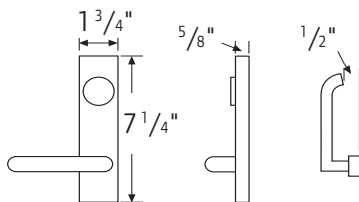

Lever projection: Quantum = 3"
 Sutro = 2 7/8"
 Dane = 2 7/8"

Key locks or unlocks trim. Lever retracts latch bolt when trim is unlocked. Dane, Quantum and Sutro levers return to within 1/2" of door.

Specifications

Hand	Non handed
Functions	See trim selection chart on this page.
Finishes	US28, DC13, DC35, US3, US10, US26, US26D Centercase and end cap are powder-coated black only.
Strikes	TD35 strike supplied standard, see page 11 for other rim strikes available.
Latch bolt	1" thickness, 3/4" throw
Dogging feature	Hex key dogging standard, except EL where must use hold back feature on outside cylinder.
Cylinder	Rim, night latch (NL) or hold back (HB) available (field selectable).
Sizes	30", 36", 42", and 48"
Doors	1 3/4" thick metal or wood, specify if wood door**
Projections	3 3/8" in neutral position, 2 3/8" in dogged position. Pushbar height is 2 1/2".
Stile	1 3/4" minimum
Electric functions	MEL - motorized electric latch retraction, requires PS900 series power supply; RX - request to exit switch, monitors pushpad OSPTD switch
Fasteners	All machine screw mounting. Device mounting fasteners are concealed, latch fasteners are exposed to egress side.
End caps	Black powder-coated metal end caps
ANSI	Carry UL label and approved for life safety. Certified ANSI A156.3 grade 1 standards.
Mullions	Removable mullions are available for pairs of doors, see page 23.

Model	Trim package	Type	Function
1790	No outside trim	4	01
1791	Pull only (9970)	4	02
1792	Cylinder only	4	03/04* or 08/09*
1794	Pull (9970) and cylinder	4	02/03/04

* Requires use of 179L

**9970 is for use on HM and Alum doors only. Not for use on wood doors.