

INSTALLATION INSTRUCTIONS FOR MAGNETIC SWITCH MS-2049SI

ELECTRICAL SPECIFICATIONS

SWITCH (SPDT)
 MAXIMUM CONTACT RATING;
 500 mA at 24V

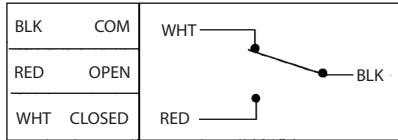

SHOWN DOOR SECURE

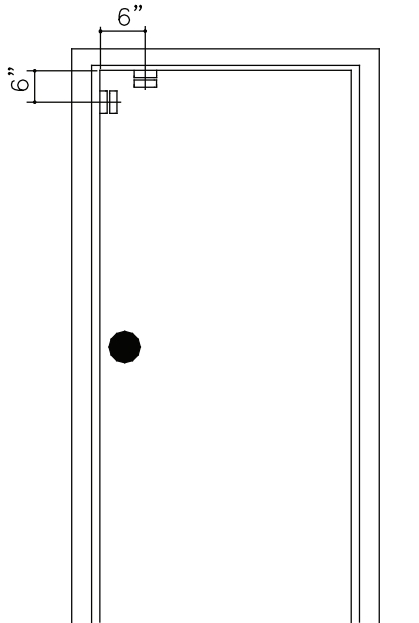

MS-2049SI POSITION

The preferred position of the magnetic switch is the top of the door, centered approximately 6" from the edge of the door, as shown. Contacts should be installed so that the door cannot be opened more than 2 inches without causing an alarm condition.

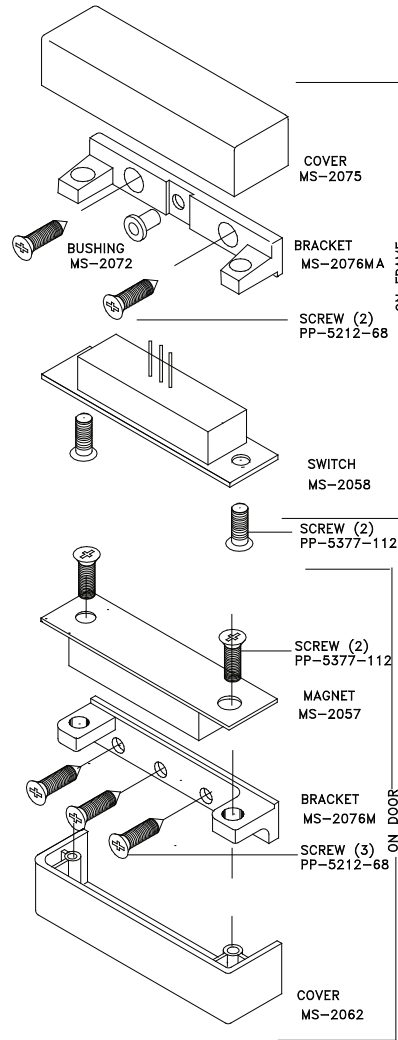

Use the template to mark the hole locations on the door and frame. The MS-2049SI should be located as shown in column 1.

Mark the hole centers and drill the holes as required on the template.

Install the bracket on the door with three screws, #10 x 1", flat head thread-forming.

Position the magnet on the bracket and slip the cover up into position. Fasten these parts together with two screws, #8-32 x 3/4", as shown.

Install the bracket on the door frame with two #10 x 1" flat-head thread-forming screws.

Press the bushing, MS-2072 into the bracket. Thread the switch wires through the bushing and position the switch on the bracket. Position the cover on the bracket and fasten the cover and switch to the bracket with two #8-32 x 3/4" flat-head screws.

Connect the switch wires to the wires from the monitoring device.

PROBLEMS?
 Contact Customer Service at
1-800-729-3839

NOTE: DIMENSIONS MAY NOT BE ACCURATE WHEN PRINTING FROM WEBSITE
PLEASE CONFIRM DIMENSIONS WITH RULER BEFORE USE

