

AVENTOS HL top

Up and Out of the Way

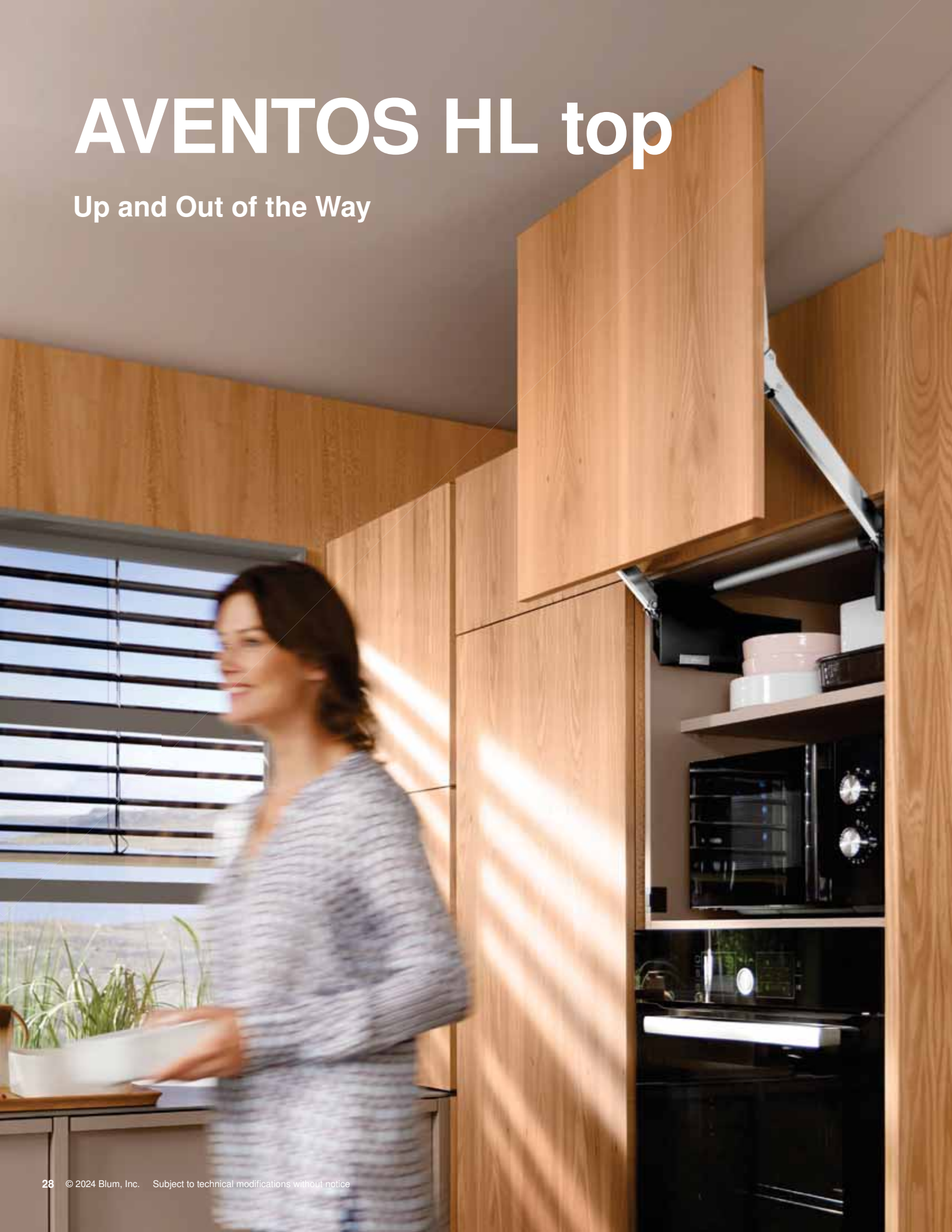

Ordering Information

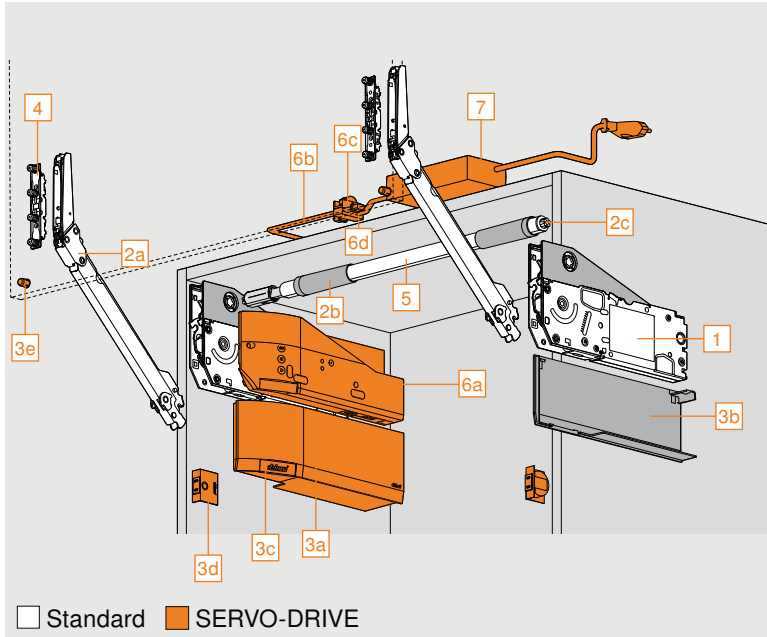

- Ideal for small one-part doors
- Ideal for appliance garage applications
- Cabinet height **300** (11-13/16") to **580** (22-13/16")
- Cabinet width up to **1828** (72")
- Inside depth of at least **264** (10-3/8")
- Integrated BLUMOTION for soft and effortless closing
- Light operating forces
- Variable stop
- Fixed position of the lift mechanism and door mounting plate
- Symmetrical levers
- Tool-free assembly
- Two lift mechanism fixing methods
- 3-dimensional adjustment of the door

Lift mechanism set <input type="checkbox"/> Standard <input checked="" type="checkbox"/> SERVO-DRIVE							
Fixing with wood screws and positioning system							
<p>1</p>	<p>Set includes:</p> <ul style="list-style-type: none"> - Symmetrical lift mechanism with positioning system (qty 2) - Wood screws Ø4 x 35 (qty 8) 						
<table border="1"> <thead> <tr> <th>Cabinet height</th> <th>Part no.</th> </tr> </thead> <tbody> <tr> <td>300 (11-3/4")–389 (15-1/4")</td> <td>22L2200</td> </tr> <tr> <td>390 (15-1/4")–580 (22-3/4")</td> <td>22L2500</td> </tr> </tbody> </table>		Cabinet height	Part no.	300 (11-3/4")–389 (15-1/4")	22L2200	390 (15-1/4")–580 (22-3/4")	22L2500
Cabinet height	Part no.						
300 (11-3/4")–389 (15-1/4")	22L2200						
390 (15-1/4")–580 (22-3/4")	22L2500						

Lift mechanism set <input type="checkbox"/> Standard <input checked="" type="checkbox"/> SERVO-DRIVE							
Fixing with pre-attached system screws							
<p>1</p>	<p>Set includes:</p> <ul style="list-style-type: none"> - Symmetrical lift mechanism with pre-attached system screws (qty 2) 						
<table border="1"> <thead> <tr> <th>Cabinet height</th> <th>Part no.</th> </tr> </thead> <tbody> <tr> <td>300 (11-3/4")–389 (15-1/4")</td> <td>22L2210</td> </tr> <tr> <td>390 (15-1/4")–580 (22-3/4")</td> <td>22L2510</td> </tr> </tbody> </table>		Cabinet height	Part no.	300 (11-3/4")–389 (15-1/4")	22L2210	390 (15-1/4")–580 (22-3/4")	22L2510
Cabinet height	Part no.						
300 (11-3/4")–389 (15-1/4")	22L2210						
390 (15-1/4")–580 (22-3/4")	22L2510						

Lever set <input type="checkbox"/> Standard <input checked="" type="checkbox"/> SERVO-DRIVE																
<p>2</p>	<p>Set includes:</p> <ul style="list-style-type: none"> 2a Symmetrical lever (qty 2) 2b Cross stabilizer cover cap (qty 2) 2c Adapter for cross stabilizer rod (qty 1) - Length adapter for cross stabilizer (qty 1) 															
Nickel-plated with steel components																
<table border="1"> <thead> <tr> <th>Cabinet height</th> <th>Door weight (lb/oz)</th> <th>Part no.</th> </tr> </thead> <tbody> <tr> <td>300 (11-3/4")–339 (13-1/4")</td> <td>3/5–19/13</td> <td>22L3200</td> </tr> <tr> <td>340 (13-3/8")–389 (15-1/4")</td> <td>3/14–22/1</td> <td>22L3500</td> </tr> <tr> <td>390 (15-1/4")–540 (21-1/4")</td> <td>4/6–27/0</td> <td>22L3800</td> </tr> <tr> <td>480 (18-7/8")–580 (22-3/4")</td> <td>5/8–30/14</td> <td>22L3900</td> </tr> </tbody> </table>		Cabinet height	Door weight (lb/oz)	Part no.	300 (11-3/4")–339 (13-1/4")	3/5–19/13	22L3200	340 (13-3/8")–389 (15-1/4")	3/14–22/1	22L3500	390 (15-1/4")–540 (21-1/4")	4/6–27/0	22L3800	480 (18-7/8")–580 (22-3/4")	5/8–30/14	22L3900
Cabinet height	Door weight (lb/oz)	Part no.														
300 (11-3/4")–339 (13-1/4")	3/5–19/13	22L3200														
340 (13-3/8")–389 (15-1/4")	3/14–22/1	22L3500														
390 (15-1/4")–540 (21-1/4")	4/6–27/0	22L3800														
480 (18-7/8")–580 (22-3/4")	5/8–30/14	22L3900														

Ordering Information

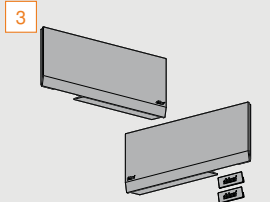
Cover cap set <input type="checkbox"/>			
 <p>3</p>	<p>Set includes:</p> <ul style="list-style-type: none"> - Cover cap left 3b Cover cap right 3c Stainless steel branding element – Blum logo (qty 2) <p>Specify color when ordering:</p> <ul style="list-style-type: none"> <input type="checkbox"/> Dark gray (TGR) <input type="checkbox"/> Silk white (SW) <input type="checkbox"/> Light gray (HGR) <p style="text-align: right;">Part no.</p> <table border="1" style="width: 100%; border-collapse: collapse;"> <tr> <td style="width: 80%;">Cover cap set</td> <td style="background-color: #f4a460; text-align: right;">22.8000.NA</td> </tr> </table>	Cover cap set	22.8000.NA
Cover cap set	22.8000.NA		

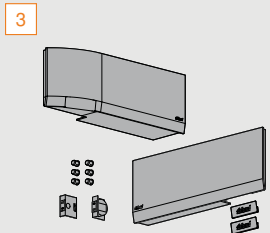
Cover cap set for SERVO-DRIVE <input checked="" type="checkbox"/>			
 <p>3</p>	<p>Set includes:</p> <ul style="list-style-type: none"> 3a SERVO-DRIVE cover cap left (qty 1) 3b Cover cap right (qty 1) 3c Stainless steel branding element – Blum logo (qty 2) 3d SERVO-DRIVE switch (qty 2) 3e Blum distance bumper Ø5 (qty 6) <p>Specify color when ordering:</p> <ul style="list-style-type: none"> <input type="checkbox"/> Dark gray (TGR) <input type="checkbox"/> Silk white (SW) <input type="checkbox"/> Light gray (HGR) <p style="text-align: right;">Part no.</p> <table border="1" style="width: 100%; border-collapse: collapse;"> <tr> <td style="width: 80%;">Cover cap set for SERVO-DRIVE</td> <td style="background-color: #f4a460; text-align: right;">23.8000.NA</td> </tr> </table>	Cover cap set for SERVO-DRIVE	23.8000.NA
Cover cap set for SERVO-DRIVE	23.8000.NA		

Branding element (optional) <input type="checkbox"/> <input checked="" type="checkbox"/>													
 <p>3c</p>	<p>Specify color when ordering dark gray (TGR) or silk white matte (SW-M)</p> <ul style="list-style-type: none"> <input type="checkbox"/> Dark gray (TGR) <input type="checkbox"/> Silk white matte (SW-M) <input type="checkbox"/> Stainless steel (IN-G) <table border="1" style="width: 100%; border-collapse: collapse; margin-top: 10px;"> <thead> <tr> <th></th> <th style="background-color: #f4a460;">SW-M, TGR</th> <th style="background-color: #f4a460;">IN-G</th> </tr> </thead> <tbody> <tr> <td>Printed* (qty 2)</td> <td style="background-color: #f4a460;">ABD.1000.BL</td> <td style="background-color: #f4a460;">ABD.1009.BL</td> </tr> <tr> <td>Embossed* (qty 2)</td> <td style="background-color: #f4a460;">ABD.1000.BT</td> <td style="background-color: #f4a460;">ABD.1009.BT</td> </tr> <tr> <td>Plain (qty 2)</td> <td style="background-color: #f4a460;">ABD.1000</td> <td style="background-color: #f4a460;">ABD.1009</td> </tr> </tbody> </table>		SW-M, TGR	IN-G	Printed* (qty 2)	ABD.1000.BL	ABD.1009.BL	Embossed* (qty 2)	ABD.1000.BT	ABD.1009.BT	Plain (qty 2)	ABD.1000	ABD.1009
	SW-M, TGR	IN-G											
Printed* (qty 2)	ABD.1000.BL	ABD.1009.BL											
Embossed* (qty 2)	ABD.1000.BT	ABD.1009.BT											
Plain (qty 2)	ABD.1000	ABD.1009											

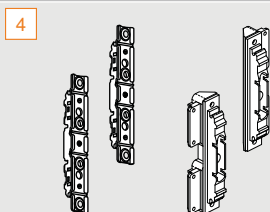

*Branding element is printed or embossed with Blum logo

Customized branding element
Printed: 1000 pc minimum
Embossed: 5000 pc minimum

Door hardware set <input type="checkbox"/> <input checked="" type="checkbox"/>							
 <p>4</p>	<ul style="list-style-type: none"> – Use 4 wood screws (606N or 606P) per side for wooden doors. – Use 4 (included) countersunk self-tapping screws (660.0950) per side for wide aluminum frames. <p style="text-align: right;">Part no.</p> <table border="1" style="width: 100%; border-collapse: collapse;"> <tr> <td style="width: 80%;">Wooden doors and wide aluminum frames</td> <td style="background-color: #f4a460; text-align: right;">20S4200</td> </tr> <tr> <td>Narrow aluminum frames</td> <td style="background-color: #f4a460; text-align: right;">20S4200A</td> </tr> <tr> <td>Large overlay 5-piece doors</td> <td style="background-color: #f4a460; text-align: right;">20S4F01</td> </tr> </table>	Wooden doors and wide aluminum frames	20S4200	Narrow aluminum frames	20S4200A	Large overlay 5-piece doors	20S4F01
Wooden doors and wide aluminum frames	20S4200						
Narrow aluminum frames	20S4200A						
Large overlay 5-piece doors	20S4F01						

EXPANDO T door mounting plate			
 <p>4</p>	<ul style="list-style-type: none"> – EXPANDO T suitable for thin fronts – see page 63 – Thin fronts (qty 2) <p style="text-align: right;">Part no.</p> <table border="1" style="width: 100%; border-collapse: collapse;"> <tr> <td style="width: 80%;">EXPANDO T door mounting plate</td> <td style="background-color: #f4a460; text-align: right;">20S42T1</td> </tr> </table>	EXPANDO T door mounting plate	20S42T1
EXPANDO T door mounting plate	20S42T1		

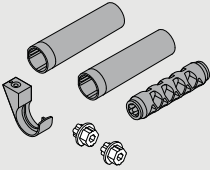
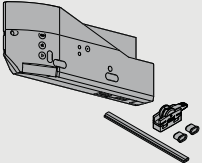
Ordering Information

Cross stabilizer <input type="checkbox"/> <input checked="" type="checkbox"/>	
<p>5 </p>	<ul style="list-style-type: none"> Length: 1076 For cutting to size: Inside cabinet width LW - 113 <p style="text-align: right;">Part no.</p> <p>Cross stabilizer 22Q1076U</p>
Connecting piece set for cross stabilizer (optional) <input type="checkbox"/> <input checked="" type="checkbox"/>	
	<p>Set includes:</p> <ul style="list-style-type: none"> Cross stabilizer cover cap (qty 2) Adapter for cross stabilizer rod (qty 2) Connecting piece for cross stabilizer (qty 1) Cross stabilizer fixing (qty 1) <ul style="list-style-type: none"> Zinc Recommended from an inside cabinet width of 1190 or a cabinet width of 1228 Cutting for 5: Inside cabinet width LW/2 - 105 <p style="text-align: right;">Part no.</p> <p>Connecting piece set for cross stabilizer 22Q080Z</p>
SERVO-DRIVE set <input checked="" type="checkbox"/>	
<p>6 </p>	<p>Set includes:</p> <ul style="list-style-type: none"> 6a SERVO-DRIVE drive unit (qty 1) 6b SERVO-DRIVE distribution cable, 1500 (qty 1) 6c Connecting node (qty 1) 6d Cable end protector (qty 2) <p>NOTE: For three lift mechanisms or more, we recommend two synchronized drive units</p> <p> Dust gray (R7037)</p> <p style="text-align: right;">Part no.</p> <p>SERVO-DRIVE set 23.A000</p>
SERVO-DRIVE power supply unit and accessories	
<p>7 See page 66 for complete ordering information</p>	

Planning

Space requirement

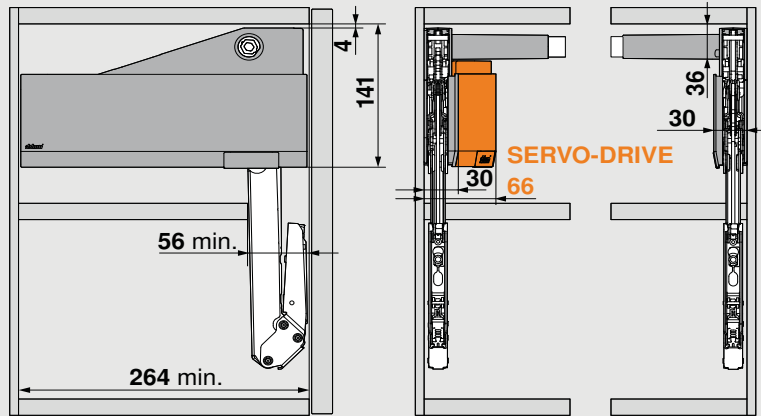

Door setting

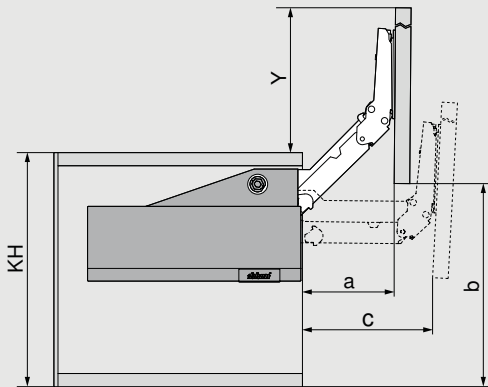

Lever set	a	b	c	Y
22L3200	112	272.5	155.5	272.5
22L3500	140.5	340	195	340
22L3800	176	425	245	425
22L3900	214.5	517	297.5	517

Dimension (b) based on bottom gap (= 0)

Dimension (Y) based on top gap (= 0)

KH = Cabinet height

Space requirement – cornice | crown molding

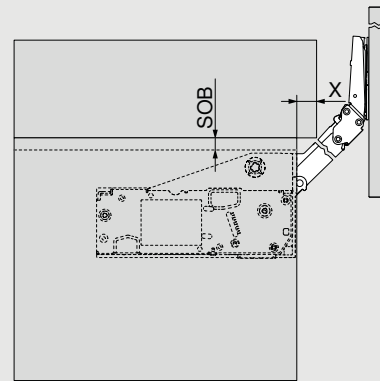

Top panel thickness (SOB)	X
16	25
17	26
18	27
19	28
20	29

Planning

Lift installation with positioning system (no pre-drilling required)

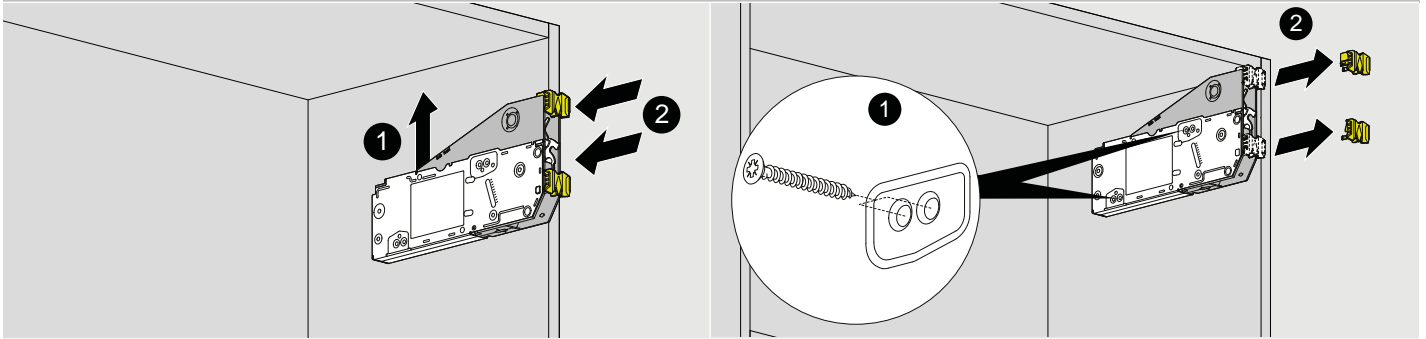

4 x wood screws Ø4 x 35

Lift installation with system screws

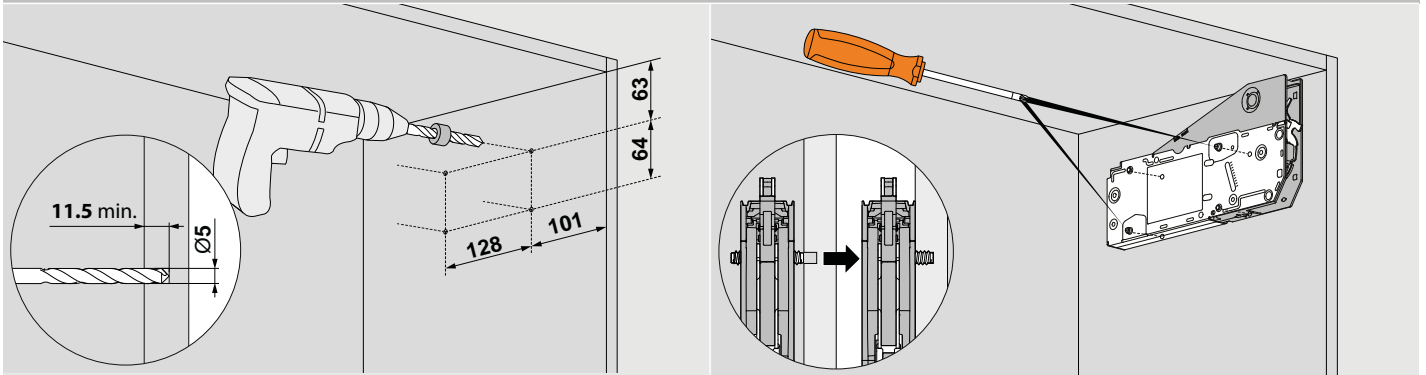

Face frame application

See page 62 for information on face frame mounting brackets.

Door Assembly

Wooden doors and wide aluminum frames

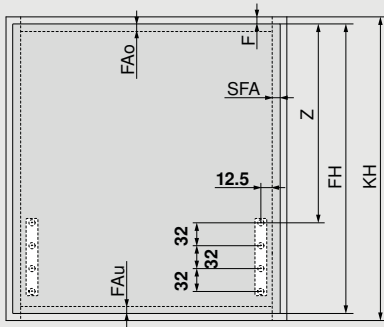

Lever set	Z
22L3200	113 + FAo
22L3500	153 + FAo
22L3800	203 + FAo
22L3900	256 + FAo

FAo = Upper door overlay
FAu = Bottom door overlay
F = Gap

FH = Door height
KH = Cabinet height
SFA = Side door overlay

Narrow aluminum frames

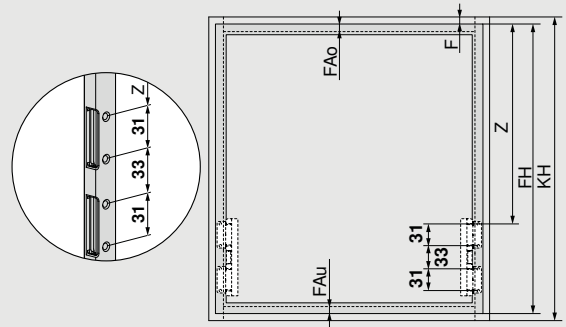

Lever set	Z
22L3200	113.5 + FAo
22L3500	153.5 + FAo
22L3800	203.5 + FAo
22L3900	256.5 + FAo

FAo = Upper door overlay
FAu = Bottom door overlay
F = Gap

Extra Wide Applications

Cross stabilizer for Inside Cabinet Width (LW) of 1190 or a Cabinet Width (KB) of 1228

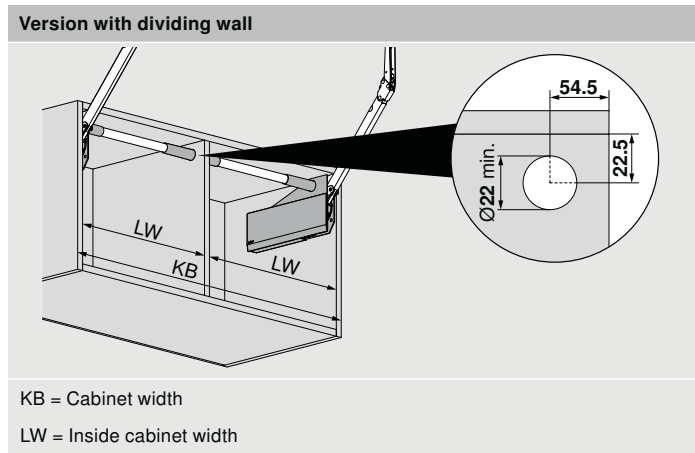
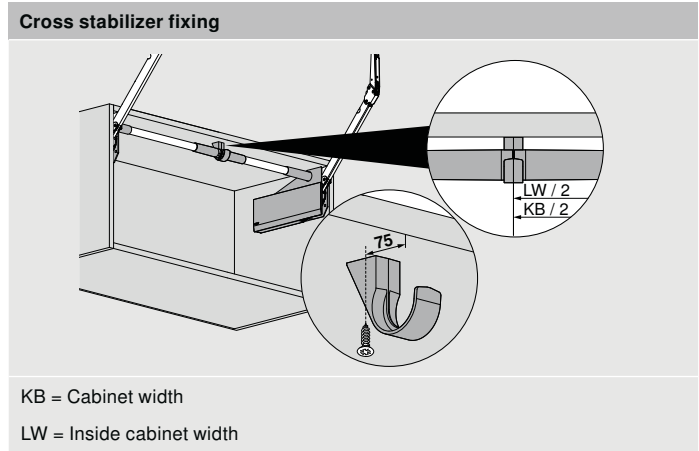
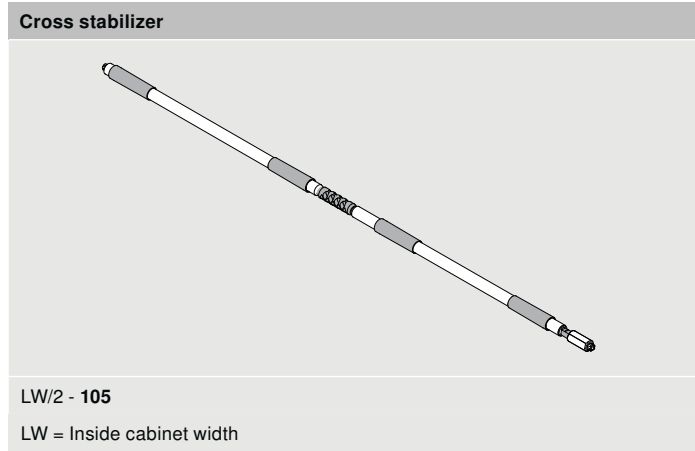

Installation and Adjustment Instructions



Use QR code or link below for AVENTOS HL top installation and adjustment instructions

www.blum.com/hltopassembly

Planning

SERVO-DRIVE for AVENTOS HL top

Blum distance bumper (SERVO-DRIVE application only)

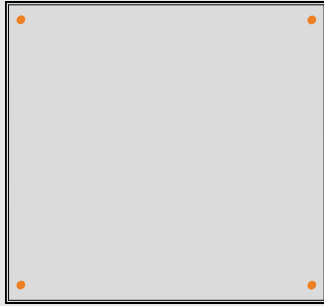

Insert Blum distance bumper (do not glue)

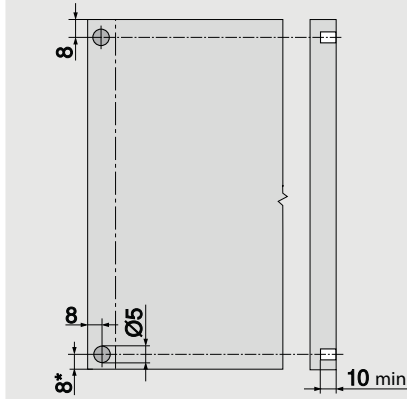

NOTE: The distance bumper should not touch the SERVO-DRIVE switch

Recommendation for aluminum frames

Consider drilling the Blum distance bumper in the cabinet side

A trial application must be carried out when fixing to the door

*From cabinet bottom edge for doors that protrude below

SERVO-DRIVE switch

