

# AVENTOS HL top

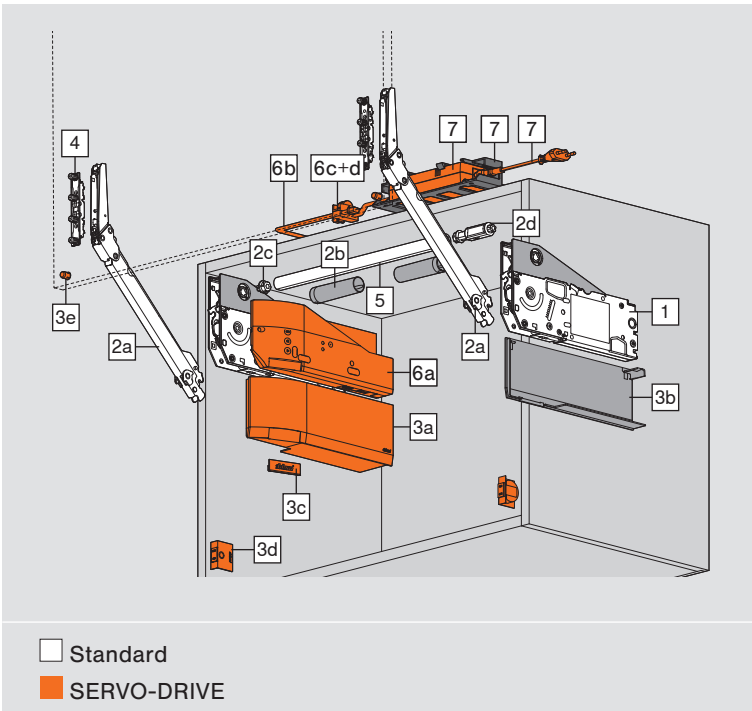



- Ideal for small one-part fronts
- Cabinet height 300-580 mm
- Cabinet width up to 1800 mm
- Internal depth of at least 264 mm
- Integrated BLUMOTION setting
- SERVO-DRIVE electrical motion support system
- Light operating forces
- Variable stop
- Standardized position of the lift mechanism and front fixing bracket
- Symmetrical lift mechanism and lever arm
- Tool-free assembly
- Two lift mechanism fixing methods
- 3-dimensional adjustment of the front

**Ordering information**

<b>1</b>	<input type="checkbox"/>	<input checked="" type="checkbox"/>	<b>Lift mechanism set</b>
	Fixing with pre-mounted system screws		
	<b>KH (mm)</b>		
	300-389		<b>22L2210</b>
	390-580		<b>22L2510</b>
KH Cabinet height			
<b>Consisting of:</b>			
<b>1</b>	2 x	Symmetrical lift mechanism Incl. pre-mounted system screws	

<b>1</b>	<input type="checkbox"/>	<input checked="" type="checkbox"/>	<b>Lift mechanism set</b>
	Fixing with chipboard screws with positioning system		
	<b>KH (mm)</b>		
	300-389		<b>22L2200</b>
	390-580		<b>22L2500</b>
KH Cabinet height			
<b>Consisting of:</b>			
<b>1</b>	2 x	Symmetrical lift mechanism Incl. positioning system	
-	8 x	Chipboard screws Ø 4 x 35 mm	

<b>2</b>	<input type="checkbox"/>	<input checked="" type="checkbox"/>	<b>Lever arm set</b>
	<b>Colour</b>		<b>Material</b>
	NI		Steel
	<b>KH (mm)</b>	<b>FG (kg)</b>	
	300-339	1.50-9.00	<b>22L3200</b>
	340-389	1.75-10.00	<b>22L3500</b>
	390-540	2.00-12.25	<b>22L3800</b>
	480-580	2.50-14.00	<b>22L3900</b>
FG Front weight including handle weight			
KH Cabinet height			
<b>Consisting of:</b>			
<b>2a</b>	2 x	Symmetrical lever arm	
<b>2b</b>	2 x	Cross stabilizer cover cap	
<b>2c</b>	1 x	Adapter for cross stabilizer rod	
<b>2d</b>	1 x	Length adapter for cross stabilizer	

**Ordering information**

<b>3</b>		<b>Cover cap set</b>		
		<b>Colour</b>	<b>Material</b>	
		SW, HGR, TGR	K	<b>22.8000.NA</b>

**Consisting of:**

-	1 x	Cover cap left
<b>3b</b>	1 x	Cover cap right
<b>3c</b>	2 x	Branding element, embossed with Blum logo
		IN-G

<b>3</b>		<b>Cover cap set for SERVO-DRIVE</b>		
		<b>Colour</b>	<b>Material</b>	
		SW, HGR, TGR	K	<b>23.8000.NA</b>

**Consisting of:**

<b>3a</b>	1 x	SERVO-DRIVE cover cap left
<b>3b</b>	1 x	Cover cap right
<b>3c</b>	2 x	Branding element, embossed with Blum logo
		IN-G
<b>3d</b>	2 x	SERVO-DRIVE switch
<b>3e</b>	6 x	Blum distance bumper Ø 5 mm

<b>4</b>		<b>Front fixing bracket set</b>		
		<b>Version</b>	<b>Fixing method</b>	
		Wooden fronts and wide aluminium frames	Screw-on <sup>1</sup>	<b>20S4200</b>
		Narrow aluminium frames	Screw-on <sup>2</sup>	<b>20S4200A</b>

**Consisting of:**

<b>4</b>	2 x	Front fixing bracket
<sup>1</sup> Use 4 chipboard screws (609.1x00) per side for wooden fronts. Use 4 countersunk self-tapping screws (660.0950) per side for wide aluminium frames.		
<sup>2</sup> Incl. 8 x countersunk self-tapping screws – 660.0950		

-		<b>Front fixing bracket</b>		
		<b>Version</b>	<b>Fixing method</b>	
		Thin fronts	EXPANDO T 2 x	<b>20S42T1</b>

EXPANDO T suitable for thin fronts – see page 54

<b>5</b>		<b>Cross stabilizer</b>		
		<b>Length (mm)</b>		
		1076		<b>22Q1076U</b>

For cutting to size

<b>Cutting</b>	Internal cabinet width LW - 113 mm
----------------	------------------------------------

-		<b>Connecting piece set for cross stabilizer</b>		
Recommended from an internal cabinet width 1190 mm or a cabinet width 1228 mm				

**Material**

Zinc	<b>22Q080Z</b>
------	----------------

**Consisting of:**

<b>2b</b>	2 x	Cross stabilizer cover cap
<b>2c</b>	2 x	Adapter for cross stabilizer rod
-	1 x	Connecting piece for cross stabilizer
-	1 x	Cross stabilizer fixing

**Cutting for 5**

Internal cabinet width LW/2 - 105 mm

<b>6</b>		<b>SERVO-DRIVE set</b>		
		<b>Colour</b>	<b>Material</b>	
		TGR	K	<b>23.A000</b>

**Consisting of:**

<b>6a</b>	1 x	Drive unit
<b>6b</b>	1 x	SERVO-DRIVE distribution cable, 1500 mm
<b>6c</b>	1 x	Connecting node
<b>6d</b>	2 x	Cable end protector

We recommend one drive unit per set for connected fronts.

<b>7</b>		<b>SERVO-DRIVE power supply unit and accessories</b>
See page 56		

**Optional**

<b>3c</b>		<b>Branding element</b>		
		<b>Material</b>	<b>Colour</b>	
		K	SW-M, TGR	IN-G
		Printed *	2 x <b>ABD.1000.BL</b>	<b>ABD.1009.BL</b>
		Embossed *	2 x <b>ABD.1000.BT</b>	<b>ABD.1009.BT</b>
		Plain	2 x <b>ABD.1000</b>	<b>ABD.1009</b>

\* With Blum logo

**From 1000 pcs:**

Customized, printed branding element

**From 5000 pcs:**

Customized, embossed branding element

**Colours and material**

Name	
SW	Silk white
HGR	Light grey
TGR	Dark grey
SW-M	Silk white matt
IN-G	In-mould brushed stainless steel
K	Nylon

Planning

**Wooden fronts and wide aluminium frames**

KB Cabinet width  
KH Cabinet height  
LT Internal cabinet depth

**Narrow aluminium frames**

KB Cabinet width  
KH Cabinet height  
LT Internal cabinet depth

**Drilling position**

**System screws**

**Chipboard screws incl. positioning system**

**Space requirement**

**Lever arm set**

Lever arm set	LH min. (mm) <sup>1</sup>
22L3200	255
22L3500	295
22L3800	345
22L3900	399

<sup>1</sup> Dimensions based on lower gap F = 0 mm

LH Internal cabinet height

**Front setting**

**Lever arm set**

Lever arm set	a (mm)	b (mm) <sup>1</sup>	c (mm)	Y (mm) <sup>2</sup>
22L3200	112	272.5	155.5	272.5
22L3500	140.5	340	195	340
22L3800	176	425	245	425
22L3900	214.5	517	297.5	517

<sup>1</sup> Dimensions based on lower gap F = 0 mm

<sup>2</sup> Dimensions based on top gap F = 0 mm

KH Cabinet height

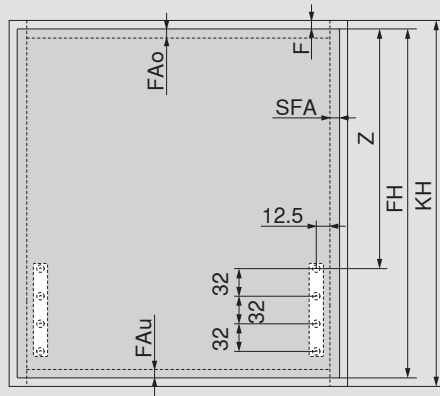
**Planning**
**Front assembly**
**Wooden fronts and wide aluminium frames**

Lever arm set	Z
22L3200	113 + FAo
22L3500	153 + FAo
22L3800	203 + FAo
22L3900	256 + FAo

FAo Upper front overlay

FAu Bottom front overlay

F Gap

FH Front height

KH Cabinet height

SFA Side front overlay

Application against a wall: minimum 5 mm gap

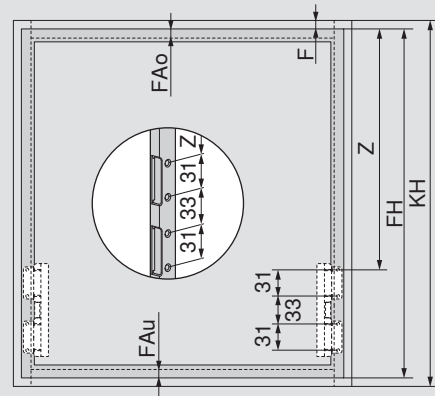
**Narrow aluminium frames**

Lever arm set	Z
22L3200	113.5 + FAo
22L3500	153.5 + FAo
22L3800	203.5 + FAo
22L3900	256.5 + FAo

FAo Upper front overlay

FAu Bottom front overlay

F Gap

FH Front height

KH Cabinet height

Application against a wall: minimum 5 mm gap

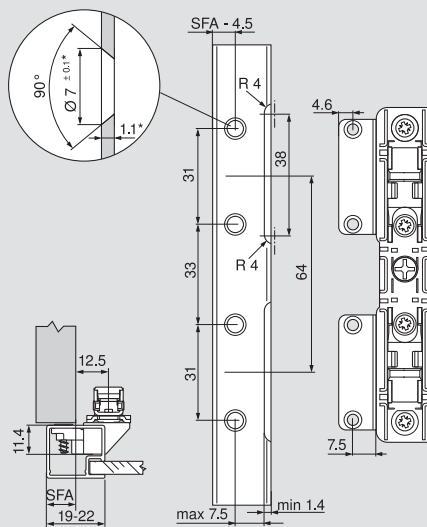
**Narrow aluminium frames**

For frame width 19 mm, an SFA of 11-18 mm is possible.

\* When changing material thickness, adjust the assembly dimensions accordingly

SFA Side front overlay

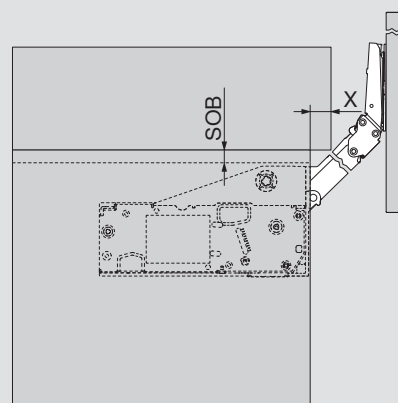
**Space requirement – cornice | crown moulding**

Top panel thickness (SOB)	X (mm)
16 mm	25
17 mm	26
18 mm	27
19 mm	28
20 mm	29

**Planning**

**Extra wide applications**

Cross stabilizer from an internal cabinet width 1190 mm or a cabinet width 1228 mm

**Cross stabilizer fixing**

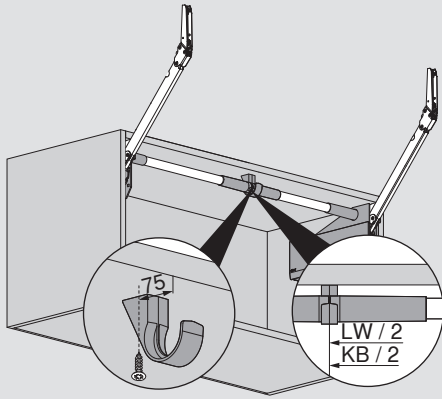

KB Cabinet width

LW Internal cabinet width

**Version with dividing wall**

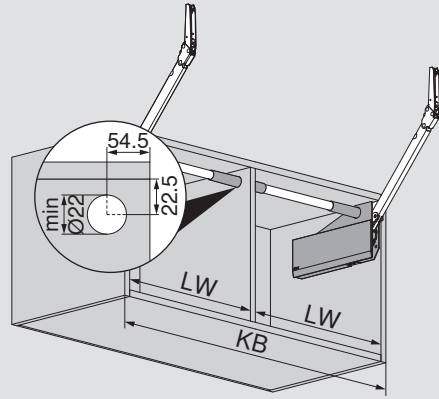

KB Cabinet width

LW Internal cabinet width



Find more information on assembly and adjustment of AVENTOS HL top at

[www.blum.com/hltopassembly](http://www.blum.com/hltopassembly)

**SERVO-DRIVE for AVENTOS HL top**

**Blum distance bumper (SERVO-DRIVE application only)**

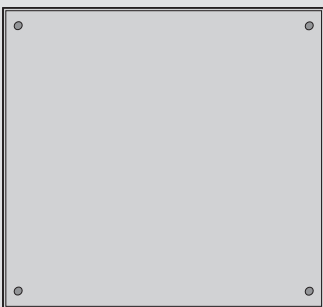

Insert Blum distance bumper (do not glue)

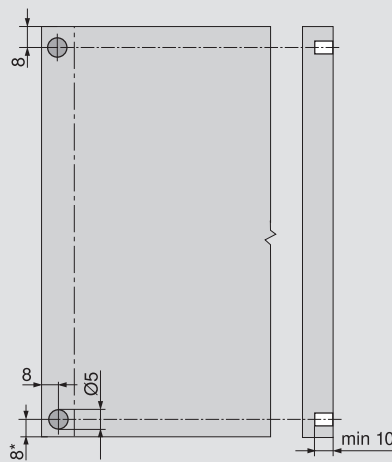

**Recommendation for aluminium frames**

Drill hole into cabinet side for Blum distance bumper

A trial application must be carried out if fixed to the front

\* From cabinet bottom edge for fronts that protrude below

**SERVO-DRIVE switch**

