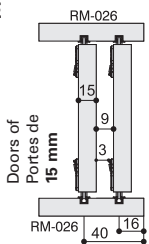
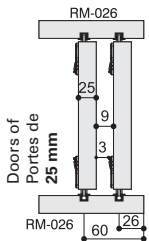
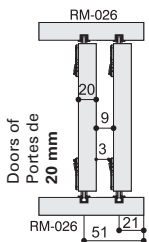
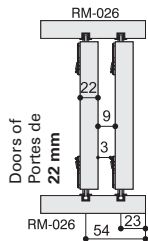
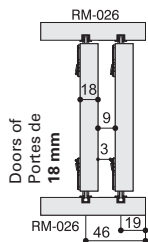
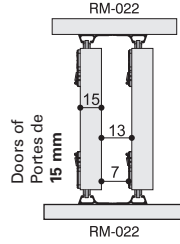
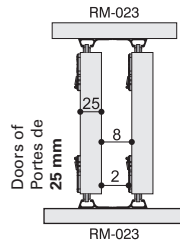
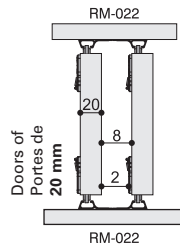
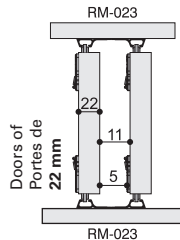
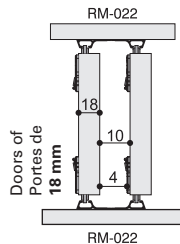
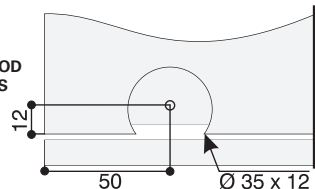
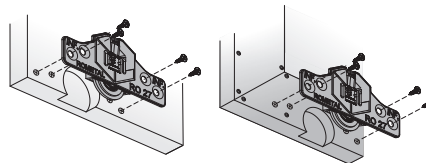
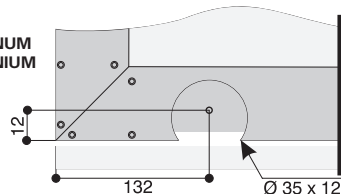

**ROMETAL****Solutions & Aluminum
Solutions et aluminium**

Cod.: 11898 | Rev.:01

**INSTALLATION MANUAL
MANUEL D'INSTALLATION****RO 27
RO 27TS**Doors up to
Portes jusqu'à
44 lb (20 kg)Door thickness
Épaisseur de porte
15 mm - 25 mm**Kit components for one door:
Composants de l'ensemble pour une porte :**2 Undercarriages with locking device, 2 Upper carriages,
2 Brakes, 1 Key2 chariots inférieurs dotés d'un mécanisme de
verrouillage, 2 chariots supérieurs, 2 freins, 1 clé**Screws indicated / Vis indiquées**Bottom carriages / Chariots inférieurs -
3.5 x 14 CC**PATENT REQUIRED
BREVET REQUIS****Recessed / Encastré**Inside cabinet height / Hauteur intérieure
du meuble - 7 mm**Surface**Inside cabinet height / Hauteur intérieure
du meuble - 15 mm

Overlap doors 20 mm to 30 mm.

L'espacement de la porte indiqué va de 25/32 po à
1 3/16 po (de 20 mm à 30 mm).**Installer, please follow the instructions carefully.
Installateur, veuillez suivre les instructions attentivement.****RECESSED / ENCASTRÉ****SPACE BETWEEN
DOORS
ESPACEMENT ENTRE
LES PORTES****SURFACE****SPACE BETWEEN
DOORS
ESPACEMENT ENTRE
LES PORTES****1****Drill holes and fix the upper and lower carriages
(dimensions in mm) / Percer les trous et fixer les
chariots inférieurs et supérieurs (dimensions en mm)****MDF/WOOD
MDF/BOIS****ALUMINUM
ALUMINIUM**

2 Install the tracks / Installer les rails

Surface mount / Montage en surface

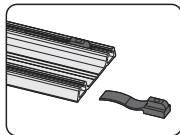

Use double-sided tape
Utiliser du ruban à deux faces



Fit the brake on the track.
Placer le frein sur le rail.

Tape not included, supplied by installer.
Ruban non inclus, fourni par l'installateur.

Recessed mount / Monture encastrée

Machining on the cabinet.
Usinage sur l'armoire.

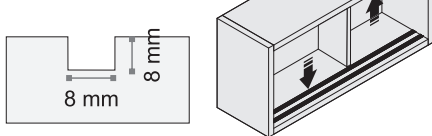

8 mm
8 mm

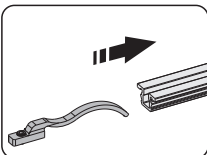

Fit the brake on the track.
Placer le frein sur le rail.

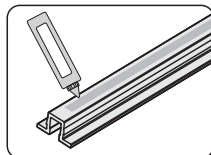

Use adhesive for fixing.
Utiliser de la adhésif pour fixer.

Install the tracks and position the brakes.
Installer les rails et positionner les freins.

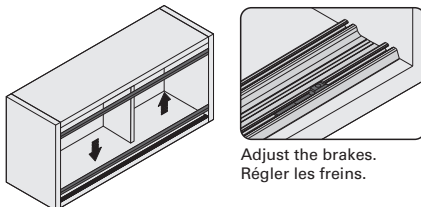

Adjust the brakes.
Régler les freins.

3 Activate the lock of the lower carriages / Activer le verrouillage des chariots inférieurs

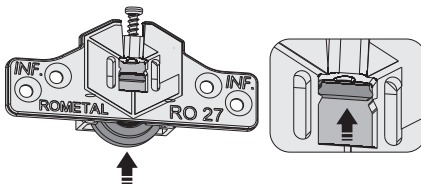

4 Fit the doors / Placer les portes

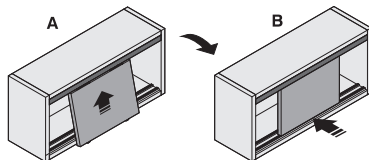

5 Unlock the carriages with the screw / Déverrouiller les chariots à l'aide de la vis

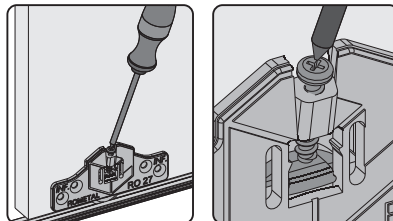

6 Adjust the door with the screw / Ajuster la porte à l'aide de la vis

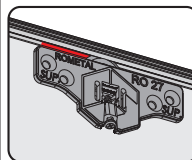
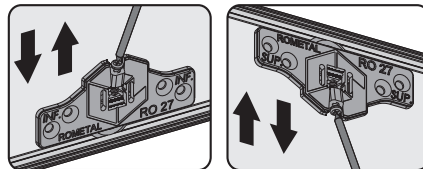

Adjust the wheel so that there is a small space between the door and the track.
Régler la roue de sorte qu'il y ait un petit espace entre la porte et le rail.

7 To remove the door, unscrew the adjusting screw and lock the lower system / Pour retirer la porte, desserrer la vis de réglage et verrouiller le système inférieur

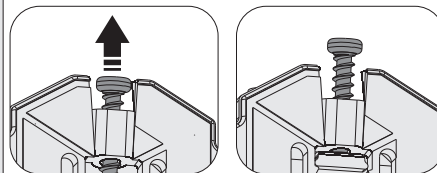

Using a Phillips screwdriver, lock the system once more and remove the door.

A l'aide d'un tournevis cruciforme, verrouiller à nouveau le système et retirer la porte.

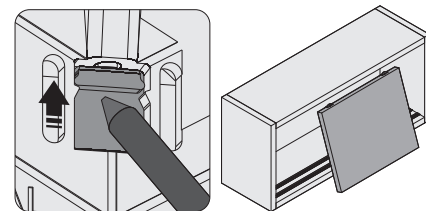

ROMETAL

Rodovia BR 470 | Km 174,5 | Nº 4075
Bairro Universal | CEP 95330-000
Veranópolis | RS | Brasil
Fone (54) 3441 3100
atendimento@rometal.com.br

www.rometal.com.br