

BED MECHANISM

MECHANISM FOR COLLAPSIBLE BED:
SINGLE - DOUBLE - QUEEN

MÉCANISME DE LIT

MÉCANISME POUR LIT ENCASTRABLE
SIMPLE - DOUBLE - GRAND «QUEEN»

28x

**Vis auto-fileteuses pour
fixer le mécanisme au
meuble.**
Self-threaded screws to
attach the mechanism to
the cabinet

4x

Vis M6 pour fixer le boîtier à ressorts

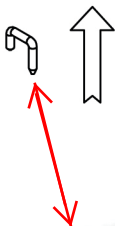
M6 screws to attach the bed frame to the bed
Mechanism (108130, 108230, 108190,
108290, 108430, or 108490)



1 Débloquer le boîtier à ressorts
Remove pin to separate the two
parts of the spring mechanism



**2 LARGEUR
WIDTH**



3 Installer le boîtier sur l'armoire
Mount the case on the cabinet with
supplied self-thread screws

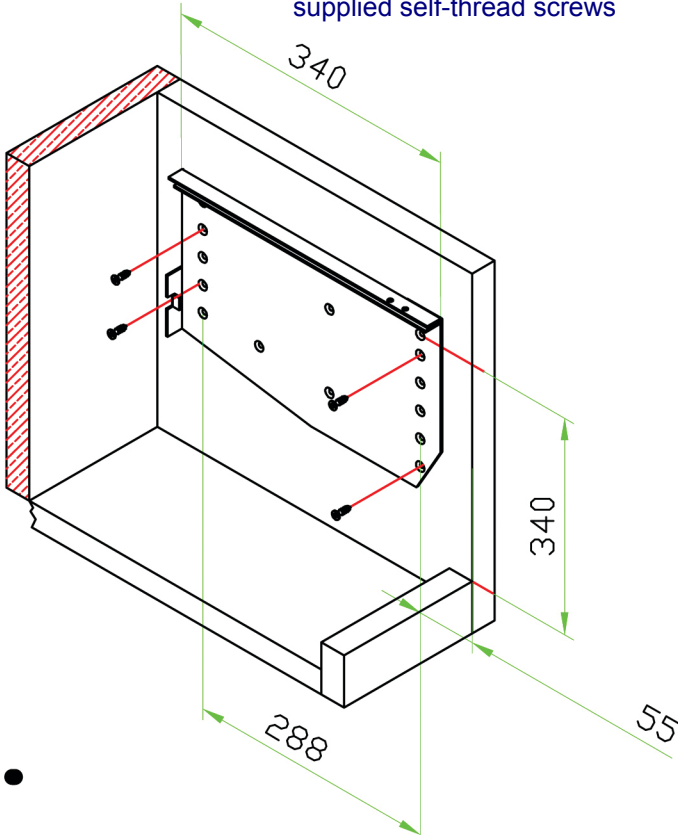

N.B.: Assurez-vous de toujours fixer l'armoire au mur
N.B.: To avoid injury the case must be firmly attached to the wall

4 Fixer le boîtier à ressorts sur le cadre du lit

Mount spring mechanism to the bed frame with supplied M6 screws

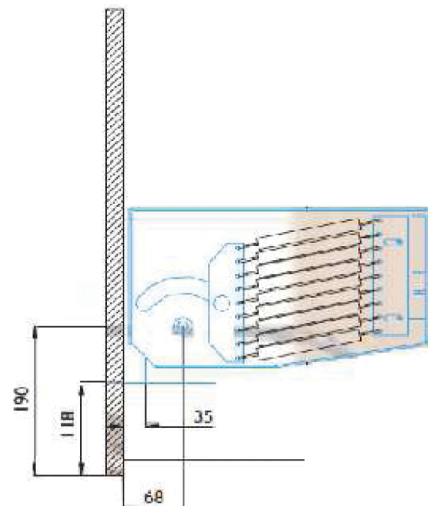
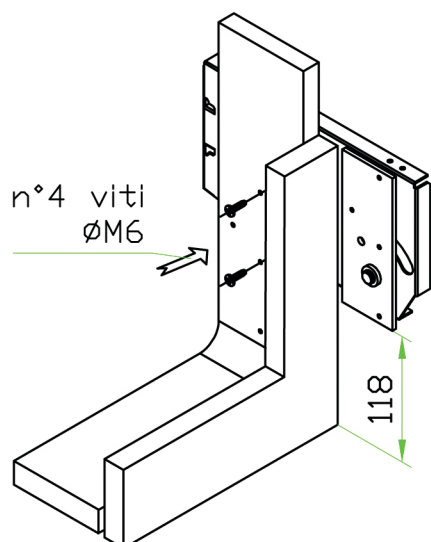

5 Insérer le cadre du lit à l'intérieur de l'armoire

après avoir installé les deux boîtes

Inserting the bed frame into the cabinet after mounting both boxes

5

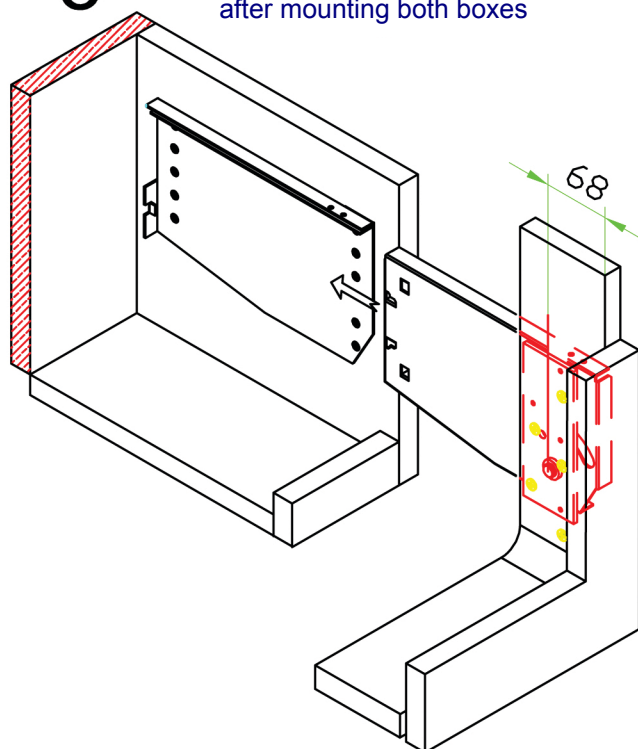

6 Faire pivoter le mécanisme en position horizontale

Rotate the mechanism to the horizontal position

6

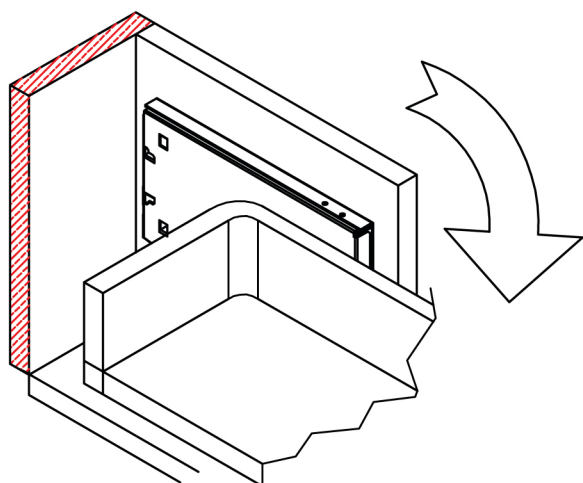

7 Verrouiller les deux parties du boîtier

Using the supplied pin, lock the two parts of the spring mechanism

7

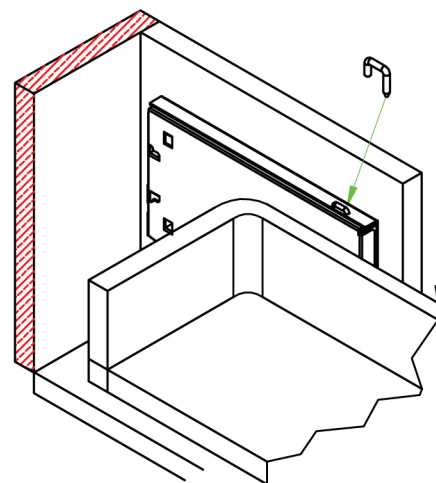

8

Ajuster la tension des ressorts à l'aide du boulon situé à l'arrière du boîtier. Pour obtenir un ajustement idéal, le lit doit rester immobile, peu importe sa position.
La distance entre le cadre de lit et l'armoire doit être de 32-33mm

Spring tension is regulated by adjusting the bolt on the back of the spring.
For proper adjustment, the bed must be able to stop and hold in all positions.
Distance between the bed frame and the cabinet must be 32-33mm

