



## Overlay Factory Setting

D = Overlay  
H = Plate height

P = Width of alu. frame  
T = Thickness of alu. frame

A = Minimum gap for alu. frame front with R=1  
L = Gap between door frame and side Panel

### Full Overlay

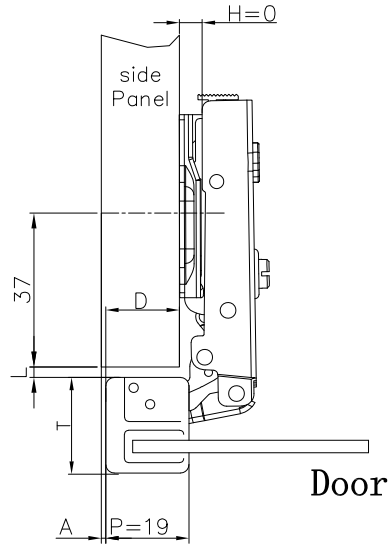

L = 15 based on factory setting, when plate setback at 37.

D \ P \ H	18	19	20	21	22	23
0	15	16	17	18	19	20
2	13	14	15	16	17	18
4	11	12	13	14	15	16

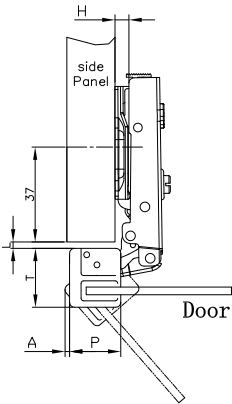

### Minimum Reveal "A"

(For alu. frame with R=1, based on factory setting)

A	T=18	T=19	T=20	T=21	T=22	T=23	T=24
P=18	0.6	0.8	1.1	1.4	1.9	2.7	3.5
P=19	0.6	0.8	1.1	1.4	1.7	2.3	3.0
P=20	0.6	0.8	1.0	1.3	1.7	2.1	2.7
P=21	0.6	0.8	1.0	1.3	1.6	2.0	2.4
P=22	0.6	0.7	1.0	1.2	1.5	1.9	2.3
P=23	0.5	0.7	0.9	1.2	1.5	1.8	2.2

### Minimum Door Gap

L	T=18	T=19	T=20	T=21	T=22	T=23	T=24
P=18	1.0	1.0	1.0	1.0	1.0	1.0	1.0
P=19	1.0	1.0	1.0	1.0	1.0	1.0	1.0
P=20	1.0	1.0	1.0	1.0	1.0	1.0	1.0
P=21	1.0	1.0	1.0	1.3	1.5	1.8	2.0
P=22	1.6	1.8	2.0	2.3	2.5	2.7	3.0
P=23	2.5	2.8	3.0	3.2	3.5	3.7	3.9

## Adjustments

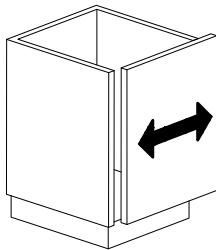

[-4, +2]

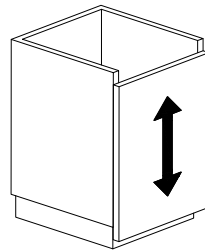

[-2, +2]

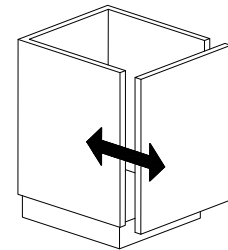

[-1.5, +2.3]

## Door Drilling

