

Note: Handlesets fit doors 1-3/4" to 2" thick.

**A**

USE INCLUDED DOOR PREPARATION TEMPLATE FOR NON-PREPARED DOORS.

Depth of edge bore holes  
2-3/8"  
3-7/8"  
1"  
1" Diameter  
Cross Bore Holes  
Edge Bore Holes  
Mortise for Faceplate  
Edge bore holes  
(Backset size See Step (C))  
1/4" Hole through door  
Cross Bore Holes  
Edge Bore Holes  
Center Line

USE INCLUDED PLASTIC TEMPLATE TO LOCATE AND DRILL THE 1/4" BOTTOM GRIP MOUNTING HOLE. (See note on reverse side.)

**B**

Install deadbolt and handleset latches.

**DO NOT USE POWER TOOLS!**

Deadbolt Tongue (Part #1A) (See D Below Before Deadbolt Latch Installation.)  
Deadbolt Latch (Part #1)  
Deadbolt Faceplate (Part #14)  
Post Holes  
Edge Bore Holes  
Handleset Latch (Part #13)  
3/4" Latch & Strike Wood Screws (Part #2)  
Latch Tongue (Part #13A)  
3/4" Latch & Strike Wood Screws (Part #2)  
Latch Faceplate (Part #14)  
Door-Inside

**C** Latch Tongue Note

Bevel side of latch tongue should contact curved end of face plate, and curved end of strike plate.

Bevel Side  
Face Plate Curve  
Strike Plate Curve

**D** Deadbolt Latch Tongue Note

Door-Inside

Deadbolt Tongue must be EXTENDED during installation.

**E** Install cylinder into plate

Door-Outside  
Cylinder Assembly (part #3)  
Tailpiece must be VERTICAL during installation.  
Spin Ring (part #3C)  
Plate (part #4)

**F**

Place cylinder assembly with plate on door exterior. Attach deadbolt adaptor plate with provided screws.

Deadbolt Adaptor Plate (part #5)  
Machine Screws (part #6)  
Door Inside  
Cylinder Assembly (part #3)

**G**

Attach thumbturn assembly with provided screws.

Thumbturn Assembly (part #7)  
5/8" machine screws (part #8)  
Door-Inside

**H** Insert handleset spindle

Door-Outside

- 1 Push down Button and Hold During Insertion
- 2 Insert Handleset Spindle (long end first, so that short end goes on door outside)

**I**

Install Exterior Handleset on Door Exterior. (part #16)

Cylinder and Plate (part #s 3 & 4)  
Door-Outside

**J**

Install long plate with knob on door inside.

Insert bottom grip mounting screw.

Adapter Plate Screws (part #18)  
Knob (Part #21)  
Long Plate (part #19)  
1" Wood Screws (part #20)  
Adapter Plate (part #17)  
Bottom Grip Mounting Screw (part #23)  
Mounting Screw Cover (part #24)  
Screw Cover Adapter (part #22)  
Door-Inside  
Door-Outside

**K** Install jamb strike plate

Dust Box (Part #9)  
Door Frame Reinforcer (Part #10)  
Strike Plate (Part #12)  
3" Wood Screws (Part #11)  
3/4" Latch & Strike Wood Screw (Part #2)  
Door Jamb

# Exploded Drawing Single Cylinder Handleset Long Plate With Pre-Attached Knob

Part Number	Part Description
-------------	------------------

- |      |   |
|------|---|
| 1.   | Deadbolt Latch  |
| 1A.  | Latch Tongue  |
| 2.   | 3/4" Latch & Strike Wood Screws (8)   |
| 3.   | Cylinder Assembly (W/Keys)  |
| 3A.  | Cylinder Body   |
| 3B.  | Tailpiece   |
| 3C.  | Spin Ring   |
| 4.   | Plate   |
| 5.   | Deadbolt Adapter Plate  |
| 6.   | 2" Machine Screws (2) for 1-3/4" thick doors. 2-1/4" Machine Screws (2) for 2" thick doors. |
| 7.   | Thumbturn Assembly  |
| 8.   | 5/8" Thumbturn Machine Screws (2)   |
| 9.   | Dustbox for Deadbolt  |
| 10.  | Door Frame Reinforcer   |
| 11.  | 3" Reinforcer Wood Screws (2)   |
| 12.  | Strike Plate for Deadbolt   |
| 13.  | Handleset Latch   |
| 13A. | Latch Tongue  |
| 14.  | Latch Faceplate   |
| 15.  | Handleset Spindle   |
| 16.  | Exterior Handleset  |
| 17.  | Adapter Plate   |
| 18.  | Adapter Plate Screws (2)  |
| 19.  | Long Plate  |
| 20.  | 1" Plate Mounting Screws  |
| 21.  | Knob  |
| 22.  | Screw Cover Adapter   |
| 23.  | 2-1/2" Bottom Grip Mounting Screw for 1-3/4" thick doors. 2-3/4" for 2" thick doors.        |
| 24.  | Mounting Screw Cover  |
| 25.  | Dustbox for Handleset   |
| 26.  | Strike Plate for Handleset  |

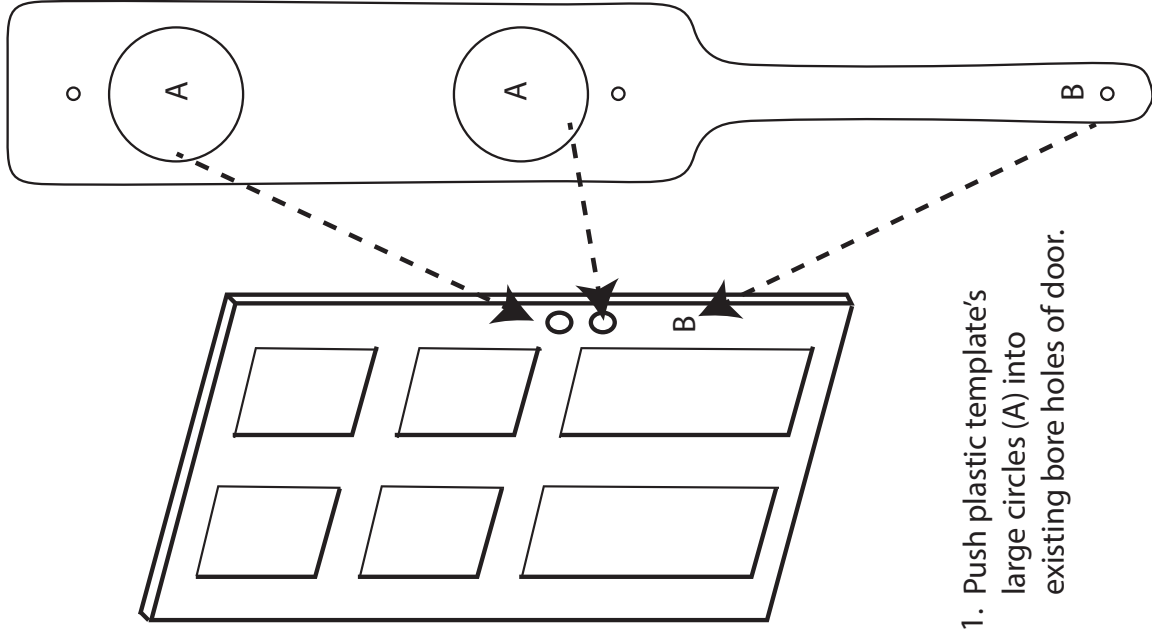

1. Push plastic template's large circles (A) into existing bore holes of door.

2. Use position of bottom hole (B) to mark and drill 1/4 inch bottom grip mounting hole.

