

# High Temperature Butt Splices

**NEW**  
BULK PACKS

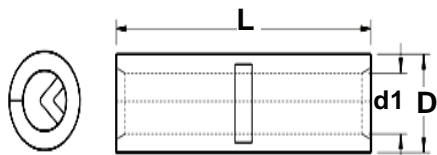

- Nickel Plated Steel
- Butted Seam
- Max Temp: 900°F (482°C)
- Applications Include: Electric space heaters, HVAC Controls, Industrial Automation, Commercial ovens and fryers, Industrial kilns

DIMENSIONS = INCHES

CAT. NO.	WIRE SIZE AWG	L	D	DI	WALL THICKNESS	BAG QTY	MASTER BOX QTY
12536	22-16	.591	.130	.067	.028	100	1,000
12538	16-14	.591	.154	.091	.028	100	1,000
<b>12538B</b>	16-14	.591	.154	.091	.028	1,000	20,000
12540	12-10	.591	.213	.134	.035	100	1,000
<b>12540B</b>	12-10	.591	.213	.134	.035	1,000	10,000

# Nylon Twin Insulated Ferrules 2 Wire - DIN Standard

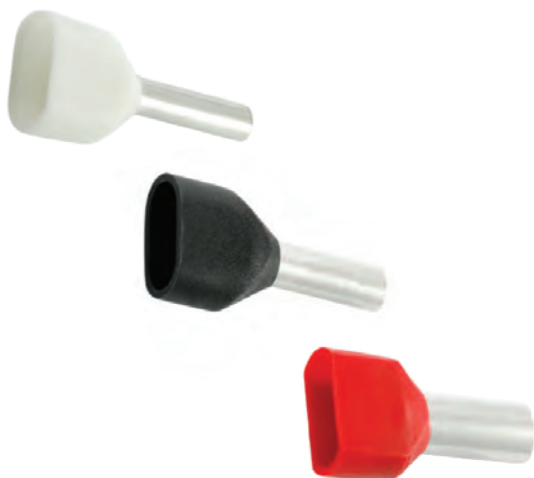

### MAXIMUM ELECTRIC CURRENT:

AWG	22	20	18	16	14	12	10
AMP	9	12	17	18	30	35	50

### TERMINAL MATERIAL:

Electro-Tin Plated Tubular Copper

**INSULATION MATERIAL:** Nylon Insulation

**FEATURES:** 2 Wire Flared Barrel, Expanded Insulation

**MAXIMUM ELECTRIC RATING:** 221°F (105°C) 600V

**COLOR CODE:** DIN Standard

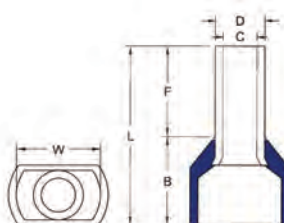

DIMENSIONS = INCHES

CAT. NO.	WIRE SIZE AWG	COLOR	F	B	L	W	D	C	BAG QTY	MASTER BAG QTY
12780	22	WHITE	.315	.256	.517	.197	.071	.059	100	1,000
12781	20	GREY	.315	.264	.579	.217	.083	.071	100	1,000
12782	20	GREY	.394	.264	.657	.217	.083	.071	100	1,000
12783	18	RED	.315	.280	.594	.217	.094	.083	100	1,000
12784	18	RED	.394	.280	.673	.217	.094	.083	100	1,000
12785	16	BLACK	.315	.295	.610	.252	.102	.091	100	1,000
12786	16	BLACK	.472	.295	.788	.252	.102	.091	100	1,000
12787	14	BLUE	.394	.235	.728	.315	.130	.114	100	1,000
12788	14	BLUE	.512	.235	.846	.315	.130	.114	100	1,000
12789	12	GREY	.472	.437	.909	.346	.165	.150	100	1,000
12790	10	YELLOW	.551	.476	1.028	.374	.209	.193	100	1,000
12791	8	RED	.551	.496	1.047	.496	.272	.256	100	1,000
12792	6	BLUE	.551	.681	1.232	.748	.343	.327	100	1,000