

Aluminum Parallel Groove Clamps



FIG. 1

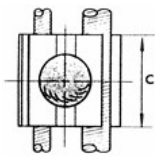

FIG. 2

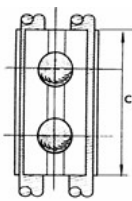
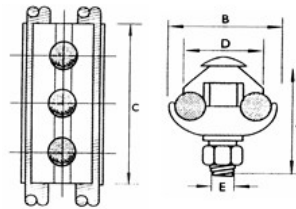

FIG. 3



- Use for Heavy Duty Service Entrance or Distribution
- Manufactured from Thermally Treated Extruded Aluminum Alloy
- High Electrical Conductivity, High Strength and Corrosion Resistance
- The Set Screw, Lock Washer and Nut Are Hot Dip Galvanized
- All Sizes Are Pre-Filled with Antioxidant Inhibitor

| CAT. NO. | FIG. | MAIN (GROOVE A) | | | TAP (GROOVE B) | | | DIMENSIONS | | | | | INNER BOX QTY | OUTER BOX QTY |
|----------|------|-----------------|-------------|-----------------|----------------|---------|-----------------|------------|-------|-------|-------|--------|---------------|---------------|
| | | CU-AL | ACSR | WIRE DIAMETER | CU-AL | ACSR | WIRE DIAMETER | A | B | C | D | E | | |
| 96016 | 1 | 10 - 2/0 | 6 - 1/0 | 0.098" - .417" | 10 - 2/0 | 6 - 1/0 | 0.098" - .417" | 1.50" | 1.50" | 1.24" | 1.14" | 0.394" | 50 | 100 |
| 96020 | 1 | 1/0 - 4/0 | 1/0 - 4/0 | 0.373" - 0.563" | 8 - 1/0 | 6 - 1/0 | 0.128" - 0.398" | 1.97" | 1.89" | 1.46" | 1.50" | 0.394" | 50 | 100 |
| 96024 | 1 | 1/0 - 397.5 | 1/0 - 336.4 | 0.373" - 0.720" | 6 - 2/0 | 6 - 1/0 | 0.162" - 0.417" | 2.36" | 2.24" | 1.67" | 1.67" | 0.394" | 50 | 100 |
| 96026 | 2 | 1/0 - 397.5 | 1/0 - 336.4 | 0.373" - 0.720" | 6 - 2/0 | 6 - 1/0 | 0.162" - 0.417" | 2.36" | 2.24" | 2.91" | 1.67" | 0.394" | - | 50 |

Aluminum Parallel & Tee Tap Connectors



- Dual Rated for Both Copper and Aluminum Conductors and Electro Tin Plated to Provide Low Contact Resistance and Protection Against Corrosion
- Manufactured from High Strength 6061-T6 Aluminum Alloy to Ensure Both Maximum Strength and Conductivity
- Dual Entry Wire Holes Allow for Parallel or Tee Tap Connectors
- Assembly Can be Made With Only a Screwdriver or Allen Wrench
- Re-Usable
- Rated 90°C
- 600 Volt

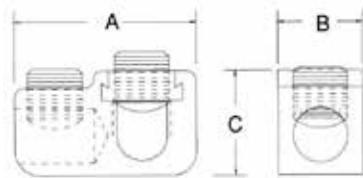

| CAT. NO. | AWG | MAIN WIRE | TAP WIRE | DIMENSIONS | | | BOX QTY |
|----------|-----------|-----------|----------|------------|-------|-------|---------|
| | | | | A | B | C | |
| 91012 | 2 | 2 - 12 | 4 - 14 | 1.39" | 0.63" | 0.88" | 50 |
| 91014 | 1/0 | 1/0 - 2 | 1/0 - 14 | 1.75" | 0.75" | 1.00" | 25 |
| 91016 | 250 - 1/0 | 250 - 1/0 | 1/0 - 14 | 2.25" | 1.00" | 1.31" | 25 |
| 91018 | 250 | 250 - 1/0 | 250 - 6 | 2.00" | 1.00" | 1.31" | 12 |
| 91020 | 350 | 350 - 4/0 | 350 - 6 | 2.56" | 1.25" | 1.44" | 12 |
| 91022 | 500 | 500 - 350 | 500 - 2 | 3.13" | 1.38" | 1.75" | 12 |
| 91023 | 750 | 750 - 500 | 500 - 2 | 3.38" | 1.50" | 2.00" | 6 |

Aluminum Parallel & Tee Tap Covers



- Flexible Covers Allow for Either Parallel or 'T' Tap Wire Entry
- Secure Snap Eliminates the Need for Taping
- Rated 90°C; 600 Volt

| CAT. NO. | AWG | COVER COLOR | DIMENSIONS | | | BOX QTY |
|----------|-----|-------------|------------|---------|----------|---------|
| | | | L | W | H | |
| 9112 | 2 | YELLOW | 2-7/32" | 1-9/32" | 1-7/64" | 12 |
| 9114 | 1/0 | GRAY | 2-5/8" | 2-5/32" | 1-1/4" | 12 |
| 9116 | 250 | RED | 3-7/16" | 2-7/8" | 1-5/8" | 12 |
| 9118 | 350 | YELLOW | 3-3/4" | 3-3/16" | 1-3/4" | 12 |
| 9120 | 500 | BLUE | 4-3/8" | 3-5/16" | 2-3/32" | 12 |
| 9122 | 750 | ORANGE | 4-5/8" | 3-7/16" | 2-11/32" | 12 |