

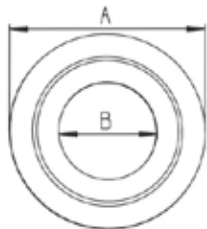

Reducing Washers



- Use to reduce the size of the knockout in a steel outlet box
- or other metal enclosure or cabinet
- Must use one inside the enclosure opening and one on the outside
- Galvanized Steel

DIMENSIONS = INCHES

CAT. NO.	TRADE SIZE	DIMENSIONS		INNER BOX	OUTER BOX
		A	B		
I4620	3/4" X 1/2"	1.44	.87	100	1,000
I4621	1" X 1/2"	1.71	.87	100	1,000
I4622	1" X 3/4"	1.74	1.10	100	1,000
I4623	1-1/4" X 1/2"	2.08	.87	50	500
I4624	1-1/4" X 3/4"	2.08	1.125	50	500
I4625	1-1/4" X 1"	2.08	1.38	50	500
I4626	1-1/2" X 1/2"	2.635	.87	50	500
I4627	1-1/2" X 3/4"	2.635	1.06	50	500
I4628	1-1/2" X 1"	2.635	1.335	50	500
I4629	1-1/2" X 1-1/4"	2.635	1.69	50	500
I4630	2" X 1/2"	3.265	.87	25	250
I4631	2" X 3/4"	3.265	1.06	25	250
I4632	2" X 1"	3.265	1.335	25	250
I4633	2" X 1-1/4"	3.265	1.69	25	250
I4634	2" X 1-1/2"	3.265	1.935	25	250

Locknuts - Zinc Die Cast

UL LISTED

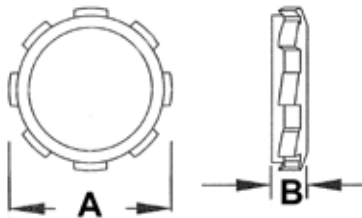

- Conduit locknuts for securing threaded conduit or connectors with tapered or straight thread, to a knockout or unthreaded slip hole

DIMENSIONS = INCHES

CAT. NO.	TRADE SIZE	DIMENSIONS		INNER BOX	OUTER BOX
		A	B		
I4720	1/2"	1.09	0.12	100	4,000
I4721	3/4"	1.36	0.14	100	2,500
I4722	1"	1.66	0.16	50	1,000

Locknuts - Steel



- Conduit locknuts for securing threaded conduit or connectors with tapered or straight thread, to a knockout or unthreaded slip hole

DIMENSIONS = INCHES

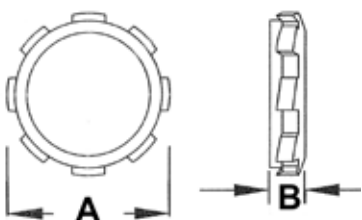

CAT. NO.	TRADE SIZE	DIMENSIONS		INNER BOX	OUTER BOX
		A	B		
I4760	1/2"	1.13	0.10	-	1,000
I4761	3/4"	1.39	0.10	-	1,000
I4762	1"	1.71	0.13	-	1,000
I4763	1-1/4"	2.07	0.13	50	500
I4764	1-1/2"	2.39	0.13	50	500
I4765	2"	2.88	0.13	25	250
I4766	2-1/2"	3.45	0.16	-	100
I4767	3"	4.14	0.16	-	100
I4768	3-1/2"	4.70	0.16	-	100
I4769	4"	5.30	0.16	-	100
I4770	5"	6.51	0.37	-	20
I4771	6"	7.85	0.37	-	20