

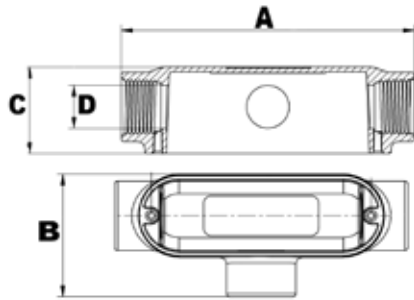

Aluminum Rigid Conduit Bodies T Type - Threaded



- Tapered Threaded Hubs (NPT)
- RainTight when used with Gasketed Covers
- Die-Cast from High-Strength, Corrosion and Weather Resistant Copper Free Aluminum Alloy
- Flat Back Design for easy mounting close to walls

To Provide Access to Conductors for Pulling, Splicing, and Maintenance. Threaded for Rigid & IMC Conduit

DIMENSIONS = INCHES

CAT. NO.	TRADE SIZE	DIMENSIONS - T SERIES				BOX QTY
		A	B	C	D	
14060	1/2"	4.72	2.03	1.36	.61	50
14061	3/4"	5.51	2.30	1.63	.81	50
14062	1"	6.46	2.68	1.89	1.04	25
14063	1-1/4"	8.35	3.52	2.50	1.37	10
14064	1-1/2"	8.35	3.52	2.50	1.60	10
14065	2"	10.55	4.27	3.41	2.06	10
14066	2-1/2"	13.46	5.89	3.98	2.46	1
14067	3"	13.46	5.89	4.53	3.06	1
14068	3-1/2"	16.30	7.66	5.60	3.54	1
14069	4"	16.30	7.66	5.60	4.02	1
WITH COVER AND GASKET						
14070	1/2"	4.72	2.03	1.36	.61	50
14071	3/4"	5.51	2.30	1.63	.81	50
14072	1"	6.46	2.68	1.89	1.04	10
14073	1-1/4"	8.35	3.52	2.50	1.37	10
14074	1-1/2"	8.35	3.52	2.50	1.60	10
14075	2"	10.55	4.27	3.41	2.06	10
14076	2-1/2"	13.46	5.89	3.98	2.46	1
14077	3"	13.46	5.89	4.53	3.06	1
14078	3-1/2"	16.30	7.66	5.60	3.54	1
14079	4"	16.30	7.66	5.60	4.02	1

Aluminum Rigid Conduit Bodies LB Type - Threaded

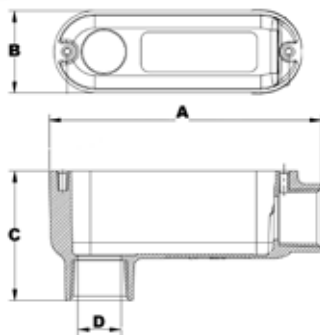

- Tapered Threaded Hubs (NPT)
- RainTight when used with Gasketed Covers
- Die-Cast from High-Strength, Corrosion and Weather Resistant Copper Free Aluminum Alloy
- Flat Back Design for easy mounting close to walls

To Provide Access to Conductors for Pulling, Splicing, and Maintenance. Threaded for Rigid & IMC Conduit

DIMENSIONS = INCHES

CAT. NO.	TRADE SIZE	DIMENSIONS - LB SERIES				BOX QTY
		A	B	C	D	
14040	1/2"	4.31	1.34	2.09	.61	50
14041	3/4"	5.08	1.56	2.39	.81	50
14042	1"	5.92	1.82	2.78	1.04	25
14043	1-1/4"	7.82	2.51	3.52	1.37	10
14044	1-1/2"	7.82	2.51	3.52	1.60	10
14045	2"	10.05	3.19	4.51	2.06	10
14046	2-1/2"	12.83	4.49	5.31	2.46	1
14047	3"	12.83	4.49	5.91	3.06	1
14048	3-1/2"	15.65	5.55	7.09	3.54	1
14049	4"	15.65	5.55	7.09	4.02	1
WITH COVER AND GASKET						
14050	1/2"	4.31	1.34	2.09	.61	50
14051	3/4"	5.08	1.56	2.39	.81	50
14052	1"	5.92	1.82	2.78	1.04	25
14053	1-1/4"	7.82	2.51	3.52	1.37	10
14054	1-1/2"	7.82	2.51	3.52	1.60	10
14055	2"	10.05	3.19	4.51	2.06	10
14056	2-1/2"	12.83	4.49	5.31	2.46	1
14057	3"	12.83	4.49	5.91	3.06	1
14058	3-1/2"	15.65	5.55	7.09	3.54	1
14059	4"	15.65	5.55	7.09	4.02	1