

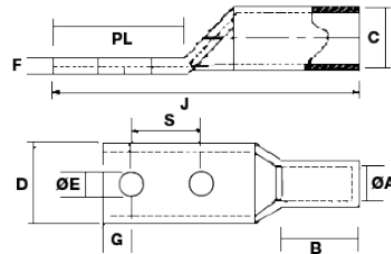

MORRIS CAT#: 94916-94162
Copper Short Barrel 2 Hole Compression Lugs



Features:

- High Conductivity Seamless Copper
- Electro-Tin Plating Resists Corrosion, Reduces Contact Resistance for Maximum Conductivity
- Dual Mounting Holes
- Color Coded Die Index and Crimp Marks Printed on Barrel
- UL 486A Listed for Applications Thru 35KV



MORRIS CAT#: 94916-94162
Copper Short Barrel 2 Hole Compression Lugs



DIMENSIONS = INCHES

CAT. NO.	WIRE RANGE	STUD SIZE	HOLE SPACING	COLOR CODE	A	G	J	B	D	F	E	G	PL	S	BOX QTY
94916	8 STR.	#8	5/8	RED	.173	.272	1.82	.44	.42	.08	.16	.28	1.26	.63	50
94110	8 STR.	#10	5/8	RED	.173	.272	1.82	.44	.42	.08	.21	.28	1.26	.63	50
94918	8 STR.	#10	3/4	RED	.173	.272	1.82	.44	.42	.08	.21	.28	1.26	.75	50
94112	8 STR.	1/4	5/8	RED	.173	.272	1.82	.44	.42	.08	.25	.28	1.26	.63	50
94920	8 STR.	1/4	3/4	RED	.173	.272	1.82	.44	.42	.08	.25	.28	1.81	.75	50
94922	8 STR.	1/4	1	RED	.173	.272	1.82	.44	.42	.08	.25	.28	1.81	1.00	50
94924	8 STR.	5/16	3/4	RED	.173	.272	1.82	.44	.42	.08	.33	.28	1.81	.75	50
94114	8 STR.	3/8	1	RED	.173	.272	1.82	.44	.42	.08	.41	.28	1.81	1.00	50
94930	6 STR.	#8	5/8	BLUE	.205	.298	2.64	.71	.42	.08	.16	.28	1.26	.63	50
94934	6 STR.	#10	1/2	BLUE	.205	.298	2.64	.71	.42	.08	.21	.28	1.26	.63	50
94116	6 STR.	#10	5/8	BLUE	.205	.298	2.64	.71	.42	.08	.21	.28	1.26	.63	50
94118	6 STR.	1/4	5/8	BLUE	.205	.298	2.64	.71	.42	.08	.25	.28	1.26	.63	50
94120	6 STR.	1/4	1	BLUE	.205	.298	2.64	.71	.42	.08	.25	.28	1.81	1.00	50
94936	6 STR.	5/16	3/4	BLUE	.205	.298	2.64	.71	.42	.08	.33	.28	1.81	.75	50
94122	6 STR.	3/8	1	BLUE	.205	.298	2.64	.71	.60	.08	.41	.38	1.81	1.00	50
94124	4 STR.	1/4	5/8	GRAY	.252	.342	2.68	.75	.49	.09	.25	.38	1.26	.63	50
94126	4 STR.	1/4	1	GRAY	.252	.342	2.68	.75	.49	.09	.25	.38	1.81	1.00	50
94128	4 STR.	5/16	1	GRAY	.252	.342	2.68	.75	.49	.09	.33	.38	1.81	1.00	50
94130	4 STR.	3/8	1	GRAY	.252	.342	2.68	.75	.56	.09	.41	.38	1.81	1.00	50
94132	2 STR.	1/4	5/8	BROWN	.315	.421	2.28	.83	.60	.10	.25	.28	1.26	.63	25
94134	2 STR.	1/4	3/4	BROWN	.315	.421	2.36	.83	.60	.10	.25	.28	1.38	.75	25
94136	2 STR.	1/4	1	BROWN	.315	.421	2.80	.83	.60	.10	.25	.28	1.81	1.00	25
94138	2 STR.	5/16	3/4	BROWN	.315	.421	2.62	.83	.60	.10	.33	.38	1.61	.75	25
94940	2 STR.	5/16	1	BROWN	.315	.421	2.62	.83	.60	.10	.33	.38	1.61	.75	25
94140	2 STR.	3/8	1	BROWN	.315	.421	2.83	.83	.60	.10	.41	.38	1.81	1.00	25
94142	2 STR.	1/2	1-3/4	BROWN	.315	.421	2.83	.83	.70	.10	.51	.62	2.99	1.75	25
94144	1 STR.	1/4	5/8	GREEN	.358	.468	2.28	.83	.67	.11	.25	.28	1.26	.63	25
94952	1 STR.	1/4	3/4	GREEN	.358	.468	2.28	.83	.67	.11	.25	.28	1.26	.75	25
94954	1 STR.	1/4	1	GREEN	.358	.468	2.28	.83	.67	.11	.25	.28	1.26	1.00	25
94146	1 STR.	5/16	1	GREEN	.358	.468	2.84	.83	.67	.11	.33	.38	1.81	1.00	25
94956	1 STR.	3/8	1	GREEN	.358	.468	2.84	.83	.67	.11	.41	.38	1.81	1.00	25
94958	1 STR.	1/2	1-3/4	GREEN	.358	.468	2.84	.83	.67	.11	.51	.62	1.81	1.75	25
94960	1/0	1/4	5/8	PINK	.389	.519	2.84	.83	.74	.12	.25	.28	1.38	.63	10
94148	1/0	1/4	3/4	PINK	.389	.519	2.84	.83	.74	.12	.25	.28	1.38	.75	10
94961	1/0	1/4	1	PINK	.389	.519	2.84	.83	.74	.12	.25	.28	1.38	1.00	10
94150	1/0	5/16	7/8	PINK	.389	.519	2.64	.83	.74	.13	.33	.32	1.62	.87	10
94152	1/0	3/8	1	PINK	.389	.519	2.83	.83	.74	.13	.41	.38	1.81	1.00	10
94154	1/0	1/2	1-3/4	PINK	.389	.519	2.83	.83	.74	.13	.51	.62	2.99	1.75	10
94962	2/0	1/4	5/8	BLACK	.440	.562	2.99	.94	.81	.11	.25	.28	1.38	.75	10
94156	2/0	1/4	3/4	BLACK	.440	.562	2.99	.94	.81	.11	.25	.28	1.38	.75	10
94963	2/0	1/4	1	BLACK	.440	.562	2.99	.94	.81	.11	.25	.28	1.38	1.00	10
94158	2/0	5/16	7/8	BLACK	.440	.562	2.99	.94	.81	.11	.33	.32	1.62	.875	10
94160	2/0	3/8	1	BLACK	.440	.562	2.99	.94	.81	.11	.41	.38	1.81	1.00	10
94162	2/0	1/2	1-3/4	BLACK	.440	.562	4.17	.94	.81	.11	.51	.62	2.99	1.75	10