

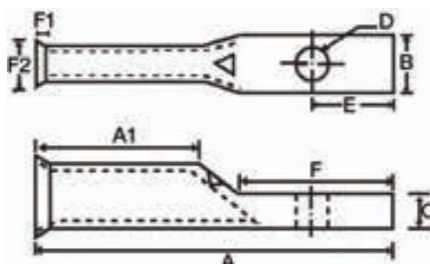

MORRIS CAT#: 94602-94647

Copper Flex Cable Short Barrel

1 Hole Compression Lugs



Features:

- High Conductivity Seamless Copper
- Electro-Tin Plating Resists Corrosion, Reduces Contact Resistance for Maximum Conductivity
- Flared/Belled Entry for Easy Insertion of Fine Strand Flexible Cable - Class G, H, I, K (Battery), M (Welding), DLO
- Color Coded Die Index and Crimp Marks Printed on Barrel
- UL 486A Listed for Applications Thru 35KV

DIMENSIONS = INCHES

CAT. NO.	WIRE RANGE	STUD SIZE	COLOR CODE	COMM	ASTM CLASS	WELDING CLASS H	WELDING CLASS M	DLO	A	AI	B	C	D	E	F	F1	F2	BOX QTY
94602	8	#10	RED	8	10	10	-	-	1.20	.44	.42	.08	.21	.28	.59	.12	.32	50
94606	6	1/4	BLUE	6	8	8	(61)	-	1.50	.71	.42	.08	.25	.30	.67	.16	.34	50
94609	4	1/4	GRAY	4	6	6	(105)	-	1.50	.71	.49	.08	.25	.31	.67	.16	.42	50
94610	4	5/16	GRAY	4	6	6	(105)	-	1.50	.71	.49	.08	.33	.31	.67	.16	.42	50
94614	2	5/16	BROWN	2	4	4	(125)	-	1.80	.83	.60	.10	.33	.37	.81	.18	.49	25
94618	1	5/16	GREEN	1	2	2	(150)	-	1.83	.83	.67	.11	.33	.37	.81	.18	.53	25
94622	1/0	3/8	PINK	1/0	1	1	(225)	-	1.83	.83	.74	.13	.41	.37	.81	.18	.56	10
94626	2/0	1/2	BLACK	2/0	1/0	1/0	(275)	-	2.24	.94	.81	.12	.51	.47	1.06	.24	.64	10
94630	3/0	1/2	ORANGE	3/0	2/0	-	2/0(325)	-	2.36	.98	.90	.13	.51	.47	1.06	.24	.72	10
94634	4/0	1/2	PURPLE	4/0	3/0	2/0	3/0(450)	-	2.36	.98	1.00	.13	.51	.47	1.06	.26	.77	10
94636	250	1/2	YELLOW	250	-	3/0	4/0(550)	-	2.48	1.06	1.09	.15	.51	.47	1.06	.26	.84	10
94637	300	1/2	WHITE	300	4/0	4/0	262.6	-	2.49	1.06	1.19	.15	.51	.52	1.06	.31	.94	10
94638	300	5/8	WHITE	300	4/0	4/0	262.6	-	2.80	1.06	1.19	.15	.67	.52	1.38	.31	.94	10
94639	350	1/2	RED	350	250	250	313.1	-	2.61	1.10	1.28	.17	.51	.52	1.06	.33	1.02	10
94640	350	5/8	RED	350	250	250	313.1	-	2.91	1.10	1.28	.16	.67	.52	1.38	.33	1.02	10
94641	400	1/2	BLUE	400	300	300	350	-	3.08	1.18	1.39	.18	.51	.52	1.38	.33	1.08	10
94642	400	5/8	BLUE	400	300	300	350	-	3.08	1.18	1.39	.18	.67	.52	1.38	.33	1.08	10
94643	500	1/2	BROWN	500	350	350	373.3	-	3.28	1.38	1.54	.22	.51	.52	1.38	.35	1.20	10
94644	500	5/8	BROWN	500	350	350	373.3	-	3.28	1.38	1.54	.22	.67	.52	1.38	.35	1.20	10
94646	600	5/8	GREEN	600	400	400	444.4	-	3.50	1.50	1.72	.25	.67	.69	1.46	.39	1.34	6
94647	750	5/8	BLACK	750	600	500	-	-	4.37	1.85	1.90	.27	.67	.69	1.85	.43	1.47	3