

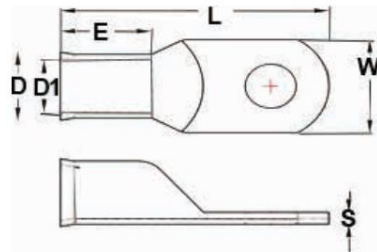

MORRIS CAT#: 92002-92016 Copper Tubular Lugs



Features:

- DC Battery, Solar and AC Electrical Applications
- High Conductivity Seamless Tubular Copper
- Electro-Tin Plated
- Flared Belled Barrel
- 105°C 600V
- UL & cUL Listed

DIMENSIONS = INCHES

CAT. NO.	WIRE AWG	STUD SIZE D2	W	D1	D	L	E	S	BOX QTY
92002	6	3/8	.55	.230	.307	1.33	.354	.067	25
92004	4	3/8	.55	.287	.358	1.40	.394	.071	25
92006	2	3/8	.65	.339	.433	1.71	.630	.091	25
92008	2	1/2	.75	.339	.433	1.71	.630	.091	25
92010	1/0	3/8	.75	.417	.512	1.85	.630	.098	25
92012	1/0	1/2	.75	.417	.512	1.85	.630	.098	25
92014	2/0	3/8	.83	.461	.563	2.05	.728	.102	25
92016	2/0	1/2	.83	.461	.563	2.05	.728	.102	25