

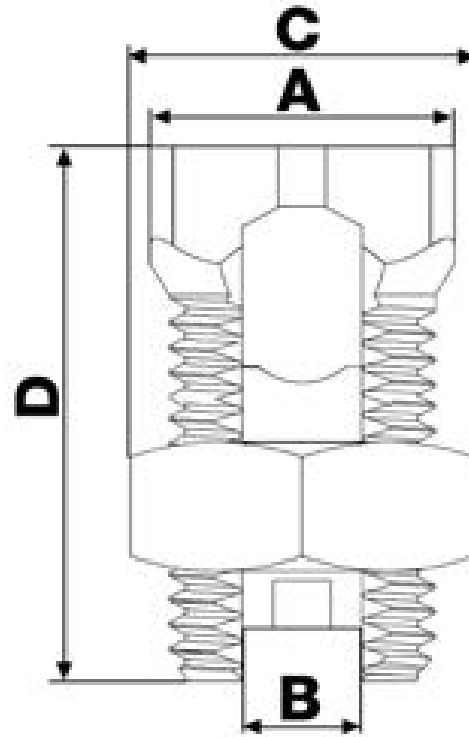

Morris CAT#: 90301 Hex Head Split Bolt #8



Features:

- Manufactured from High Strength High Conductivity Electrolytic Copper Alloy to Ensure Both Maximum Strength and Conductivity
- Rated for Copper Conductors Only
- Connectors are Re-Usable
- Rated 600V; 194°F (90°C)
- UL486 UL 486A-486B & CSA C22.2 No. 65-13
- UL 467 Listed for Direct Burial & Grounding/Bonding

Part#	AWG	Max Run to Max Tap	Min. Run to Min. Tap	Max Run to Min Tap	Min Equal Tap & Run	Torque in LB	Dimensions			
							A: 1/2"	B: 1/8"	C: 9/16"	D: 7/8"
90301	8	8-8	16-16	8-16	16-16	80	A: 1/2"	B: 1/8"	C: 9/16"	D: 7/8"