

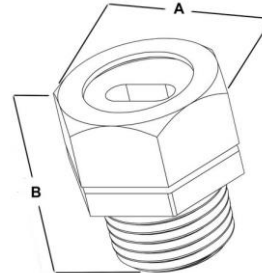

Morris CAT#: 15370-15382
Water-Tight Service Entrance Connectors -
Zinc Die-Cast



Features:

- Compression Type SEU Connector
- Used to Connect Service Entrance Cable to a Service Enclosure in Wet Locations
- Accepts 2 Insulated Conductors, 1 Bare
- U/Flat Style Conductor Only
- Assembled with Rubber Grommet and Washer
- Locknut Included

DIMENSIONS = INCHES

CAT. NO.	TRADE SIZE	CABLE SIZE	MAX GROMMET OPENING		OVERALL DIMENSIONS		INNER BOX	OUTER BOX
			LENGTH	WIDTH	A	B		
15370	1"	#8	.67	.40	1.67	1.45	20	100
15371	1"	#6	.77	.50	1.67	1.45	20	100
15372	1"	#4	.81	.53	1.67	1.45	20	100
15373	1-1/4"	#3	.92	.56	2.05	1.80	10	50
15374	1-1/4"	#2	.98	.59	2.05	1.80	10	50
15375	1-1/4"	#1	1.09	.65	2.05	1.80	10	50
15377	1-1/2"	#2/0	1.34	.86	2.31	2.02	10	50
15379	2"	#2/0	1.34	.86	2.82	2.39	5	25
15380	2"	#3/0	1.37	.87	2.82	2.39	5	25
15381	2"	#4/0	1.50	.90	2.82	2.39	5	25
15382	2"	#4/0	1.73	1.11	2.82	2.39	5	25