

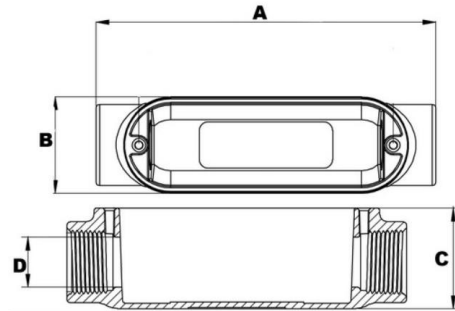

Morris CAT#: 14120-14129
Aluminum Rigid Conduit Bodies
C Type-Threaded



Features:

- Tapered Threaded Hubs (NPT)
- RainTight when used with Gasketed Covers
- Die-Cast from High-Strength, Corrosion and Weather Resistant Copper Free Aluminum Alloy
- Flat Back Design for easy mounting close to walls
- For use with Rigid or IMC Conduit
- Cover & Gasket not included

DIMENSIONS = INCHES

CAT. NO.	TRADE SIZE	DIMENSIONS-C SERIES				BOX QTY
		A	B	C	D	
14120	1/2"	4.72	1.34	1.36	.61	50
14121	3/4"	5.51	1.56	1.63	.81	50
14122	1"	6.46	1.82	1.89	1.04	25
14123	1-1/4"	8.35	2.51	2.50	1.37	10
14124	1-1/2"	8.35	2.51	2.50	1.60	10
14125	2"	10.55	3.19	3.41	2.06	10
14126	2-1/2"	13.46	4.49	3.98	2.46	1
14127	3"	13.46	4.49	4.53	3.06	1
14128	3-1/2"	16.30	5.55	5.59	3.54	1
14129	4"	16.30	5.55	5.59	4.02	1