

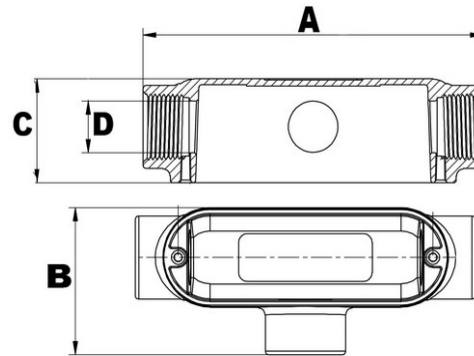

**Morris CAT#: 14060-14069**  
**Aluminum Rigid Conduit Bodies**  
**T Type-Threaded**



**Features:**

- Tapered Threaded Hubs (NPT)
- RainTight when used with Gasketed Covers
- Die-Cast from High-Strength, Corrosion and Weather Resistant Copper Free Aluminum Alloy
- Flat Back Design for easy mounting close to walls
- For use with Rigid or IMC Conduit
- Cover & Gasket not included

DIMENSIONS = INCHES

CAT. NO.	TRADE SIZE	DIMENSIONS - T SERIES				BOX QTY
		A	B	C	D	
14060	1/2"	4.72	2.03	1.36	.61	50
14061	3/4"	5.51	2.30	1.63	.81	50
14062	1"	6.46	2.68	1.89	1.04	25
14063	1-1/4"	8.35	3.52	2.50	1.37	10
14064	1-1/2"	8.35	3.52	2.50	1.60	10
14065	2"	10.55	4.27	3.41	2.06	10
14066	2-1/2"	13.46	5.89	3.98	2.46	1
14067	3"	13.46	5.89	4.53	3.06	1
14068	3-1/2"	16.30	7.66	5.60	3.54	1
14069	4"	16.30	7.66	5.60	4.02	1