

# Reader (Mullion Style) 26bit Wiegand HID® Compatible

PP08MRDR  
PP08MSGR

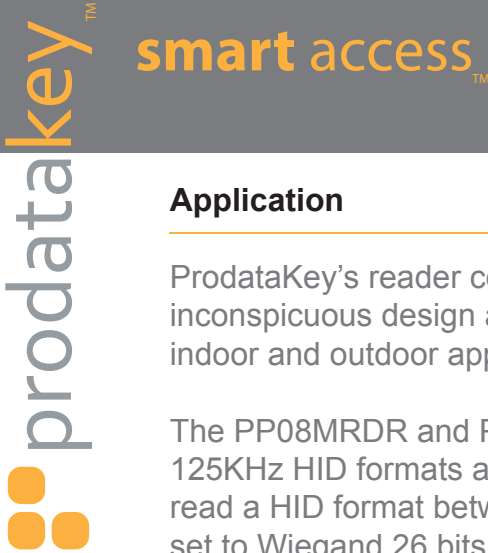

## Application

ProdataKey's reader combines multiple configuration options with an attractive, inconspicuous design and economical price. Its secure potted electronics are ideal for both indoor and outdoor applications.

The PP08MRDR and PP08SGR are Wiegand Output Proximity Readers. 125KHz EM and 125KHz HID formats are compatible with these readers. These readers have the ability to read a HID format between Wiegand ranges of 26 bits - 37 bits. The default EM bit range is set to Wiegand 26 bits.

## Specifications

**Operating Voltage:** 9 ~ 18V D C

**Frequency:** 125K Hz

**Card Type:** EM card and HID card format

**Reading Distance:** 1 3/8 to 3 1/8"

**Output:** HID Wiegand 26 - 37, EM Wiegand 26

**Environmental:** Indoor/outdoor, waterproof  
Temperature: -40° F ~ 140° F  
Humidity: 10% - 98% relative humidity non condensing

**Standby Current:** ≤25 mA

**Index of Protection:** IP 66

**Enclosure (L x W x H):** 4 3/4" x 1 7/8" x 7/8"  
4 3/4" x 3" x 7/8"

**Wiring:** Red: Power +  
Black: Ground  
Green: Wiegand D0  
White: Wiegand D1  
Brown: Green LED Light Control (GND)  
Yellow Buzzer Control (GND)



## Measurements

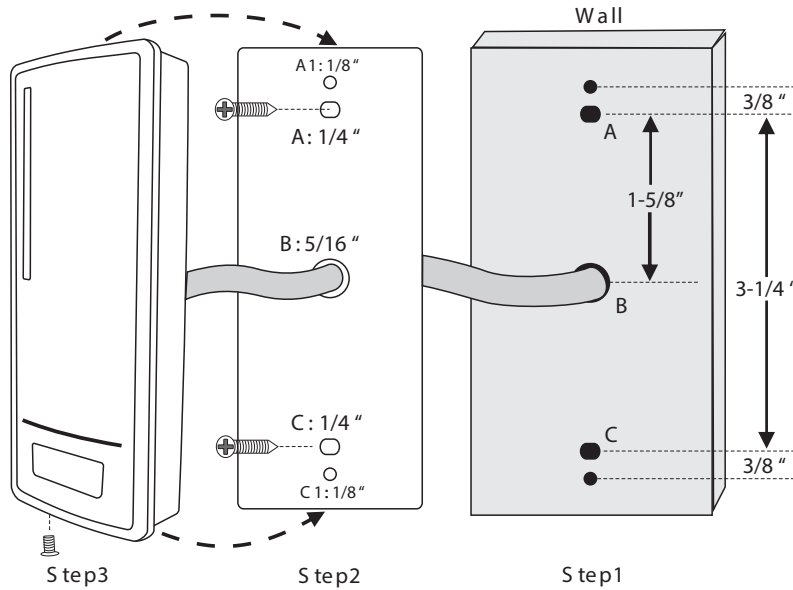

## Features

**Mounting:** The reader will need three holes, two for mounting and one for the cable.

**Diagnostics:** On controller power-up, an internal self-test routine checks and verifies the setup configuration, determines the boot of firmware along with connection through LED indicator, and initializes controller operation. An additional connection test in the software allows for the controller to be detected and determine functionality.

**Tamper:** The readers have a built-in light sensor to signal when the keypad is being tampered.

**Easily Interfaced:** Connection to the door controller using the included five wire pigtail.

**Security:** Each reader includes a security screw and sound alarm.

**Warranty:** 2 Year warranty against defects in materials and workmanship (see complete policy for details).

**Part Numbers:** Mullion (26 bit wiegand) Reader PP08MRDR  
Single Gang (26 bit wiegand) Reader PP08MRDR

**Indicators:** **GREEN LED:** Accepted Entry  
**RED LED:** Denied Entry