

# DOUBLE & SINGLE BITTED CAM LOCKS

## DOUBLE BITTED

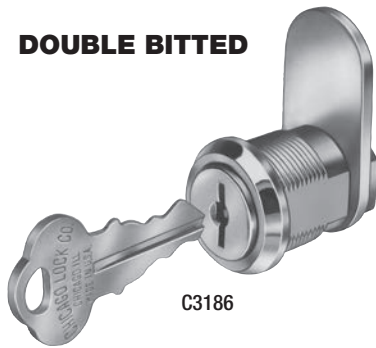

C3186

- Eleven criss-cross blade tumbler plug in  $\frac{3}{4}$ " diameter.
- Die cast barrel with two flats —  $\frac{5}{8}$ " across.
- Key and cam rotation  $90^\circ$  from locked (12 O'Clock) to unlocked (3 O'Clock) position with keypull in locked position only.
- Straight cam furnished is  $\frac{1}{8}$ " thick X  $\frac{3}{4}$ " wide.
- Polish Nickel finish.
- Two keys per lock.
- Not available MK.
- DK-45 key blank.

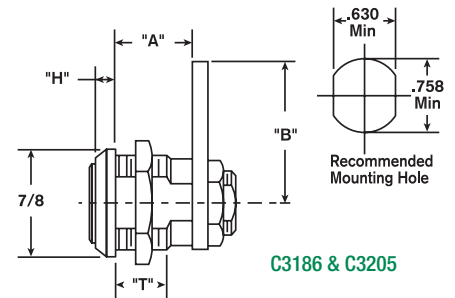

Lock No.	"A" Dim.	"B" Dim.	"H" Dim.	"T" Dim.	KA Codes	KD Changes
C3205	$\frac{7}{16}$ "	$1\frac{1}{8}$ "	$\frac{13}{64}$ "	$\frac{15}{64}$ "	2001 2007	200
C3186	$\frac{5}{8}$ "	$1\frac{1}{8}$ "	$\frac{5}{32}$ "	$\frac{13}{32}$ "	2001 2007	200
C1801	$\frac{13}{16}$ "	$1\frac{1}{8}$ "	$\frac{13}{64}$ "	$\frac{11}{16}$ "	2001	—
C1802	$1\frac{1}{16}$ "	$1\frac{1}{8}$ "	$\frac{13}{64}$ "	$\frac{15}{16}$ "	2001 2007	—
1803 DK-4 keyway only	$\frac{13}{16}$ "	$1\frac{1}{8}$ "	$\frac{13}{64}$ "	$\frac{17}{64}$ "	2141	200
C1804	$1\frac{1}{2}$ "	$1\frac{1}{8}$ "	$\frac{13}{64}$ "	$1\frac{13}{32}$ "	2001	—

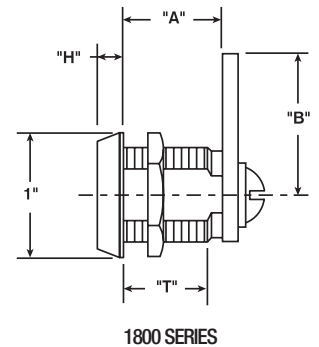

## SINGLE BITTED



- Five disc tumbler plug in  $\frac{3}{4}$ " diameter.
- Die cast barrel with two flats —  $\frac{5}{8}$ " across.
- Key and cam rotation  $90^\circ$  from locked (12 O'Clock) to unlocked (3 O'Clock) position with keypull in locked position only.
- Straight cam furnished is  $\frac{1}{8}$ " thick X  $\frac{3}{4}$ " wide.
- Polish Nickel finish.
- Two keys per lock.
- Available in six disc tumbler.
- DK-5 key blank.

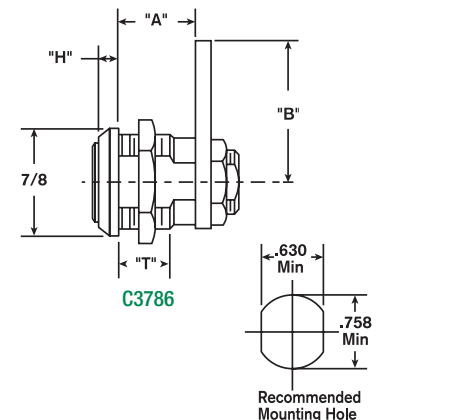

Lock No.	"A" Dim.	"B" Dim.	"H" Dim.	"T" Dim.	KA Codes	KD Changes
3705	$\frac{7}{16}$ "	$1\frac{1}{8}$ "	$\frac{1}{4}$ "	$\frac{13}{64}$ "	1289 1454	200
C3786	$\frac{5}{8}$ "	$1\frac{1}{8}$ "	$\frac{13}{64}$ "	$\frac{13}{32}$ "	1289 1454	200
C1701	$\frac{13}{16}$ "	$1\frac{1}{8}$ "	$\frac{13}{64}$ "	$\frac{11}{16}$ "	1289 1454	200
C1702	$1\frac{1}{16}$ "	$1\frac{1}{8}$ "	$\frac{13}{64}$ "	$\frac{15}{16}$ "	1454	200
C1703	$\frac{13}{16}$ "	$1\frac{1}{8}$ "	$\frac{13}{64}$ "	$\frac{17}{64}$ "	1289 1454	200
C1704	$1\frac{1}{2}$ "	$1\frac{1}{8}$ "	$\frac{13}{64}$ "	$1\frac{13}{32}$ "	1289 1454	200

