

Trim Selection



LEVER DESIGN

Non-handed Grade 1 (Clutch Style)

Cylindrical body hardened steel heavy duty tailpiece. For 1 3/4" and 2 1/4" doors. Prefix THI before part # for 2 1/4" door thickness. Available for fire and non fire rated rim and vertical rod exit devices.

Rose diameter 3 1/2", lever length 4 3/4". Fits and covers 161 cutout.

Finishes: Architectural plated finishes.

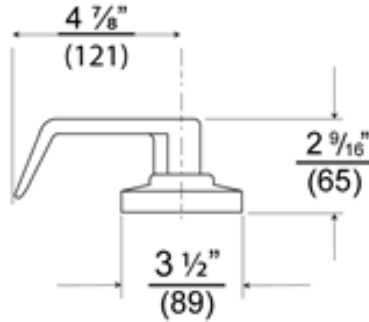
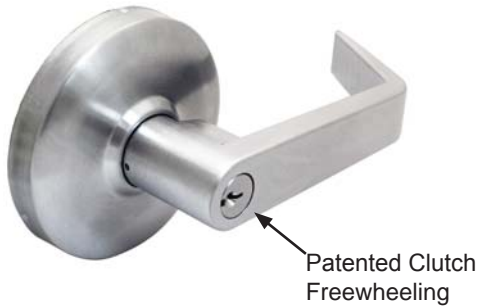

- ENT00L or
- ICENT00L or
- ICSCENT00L4
- SARICENT00L (Sargent)
- RUSICENT00L (Corbin/Russwin)
- YALICENT00L (Yale)
- 8000K

- ENTRANCE**
Key locks and unlocks lever. Operates as CLASSROOM FUNCTION.
ANSI Function – 08

Ball Knob Keylock

- STR05L or
- ICSTR05L or
- ICSCSTR05L4
- SARICSTR05L (Sargent)
- RUSICSTR05L (Corbin/Russwin)
- YALICSTR05L (Yale)

- STOREROOM**
Key operates lever, otherwise always locked.
ANSI Function – 04

PAS30L

- PASSAGE**
Trim always operable and free.
ANSI Function - 15

DUM40L

- DUMMY**
Dummy trim. One sided
ANSI Function – 10

When ordering "AT" and "SPA" designs, prefix design name before part #. Example: ENT00L in "AT" is **ATENT00L**.

KEYWAY: 6 pin solid brass "C" keyway standard. Optional: Schlage E, Schlage C-K, Russwin D1-2-3-4, Corbin 59/60, Sargent LA-LB-LC, Falcon/Weiser E, Arrow A, Yale 8, Yale GA and Kwikset. Can also accept Medeco, Assa, Kaba and **Cal-Royal HSK** High Security Cylinders.

- (IC) **INTERCHANGEABLE CORE:** Interchangeable Core locks will accept compatible 6 or 7 pin cores with BEST, FALCON and ARROW.
- (ICSC) **INTERCHANGEABLE CORE:** Indicates function available with Schlage Full size format Interchangeable Core.

Other Lever Trim Designs



TUB DESIGN

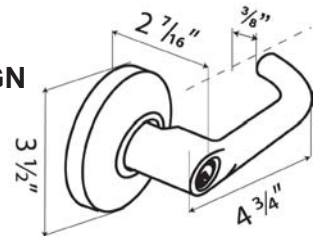

AT DESIGN

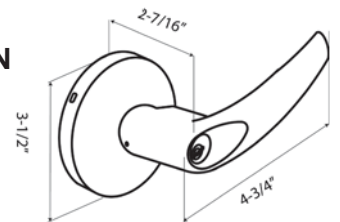

SPA DESIGN

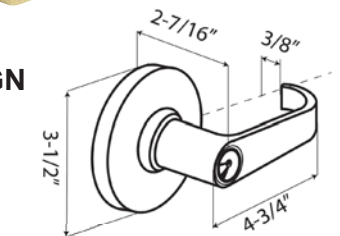

8000K

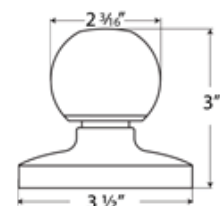

Trim Selection

ESCUTCHEON LEVER DESIGN

CONSTRUCTION

- Rigid, non clutch mechanism.
- Double heavy duty spring support to prevent sagging and enhance operation.
- Grade 1, thru-bolted design. Non-handed design. Easily field reversible.
- Hardened steel heavy duty tailpiece. Available for fire and non fire rated rim and vertical rod exit devices.

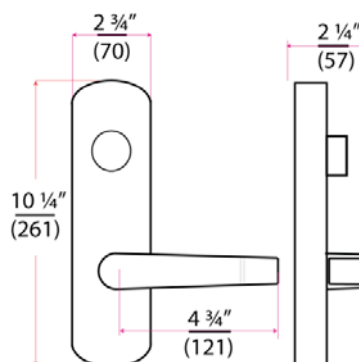

DOOR THICKNESS

Standard 1 3/4". For 2 1/4" thick door use additional part# TAIL3

ESCUTCHEON DIMENSIONS

2 3/4" width X 10 1/4" length. Lever length: 4 3/4". Fits and covers 2 1/8" 161 cutout

- ESC9800 or
- ICESC9800 or
- ICSCESC9800

ENTRANCE

Rigid Entrance, key locks or unlocks escutcheon trim
ANSI FUNCTION (63) Operates as classroom function

- ESC9805 or
- ICESC9805 or
- ICSCESC9805

STOREROOM

Rigid Storeroom, key unlocks lever, lever retracts latch bolt, otherwise always locked
ANSI FUNCTION (04)

ESC9830

PASSAGE

Trim always operable and free
ANSI Function (62)

ESC9840

DUMMY

Dummy Escutcheon trim ANSI FUNCTION (10)

TO ORDER other lever design insert "AT" or "RL" before "ESC":
e.g. **ATESC9800** for ESC9800 with AT design or **RLESC9800** for ESC9800

KEYWAY: 6 pin solid brass "C" keyway Mortise Cylinder standard. Optional: Schlage E, Schlage C-K, Russwin D1-2-3-4, Corbin 59/60, Sargent LA-LB-LC, Falcon/Weiser E, Arrow A, Yale 8, Yale GA and Kwikset. Can also accept Medeco, Assa, Kaba and **Cal-Royal HSK** High Security Cylinders.

• **(IC) INTERCHANGEABLE CORE:** Interchangeable Core locks will accept compatible 6 or 7 pin cores with BEST, FALCON and ARROW.

• **(ICSC) INTERCHANGEABLE CORE:** Indicates function available with Schlage Full size format Interchangeable Core.

Lever Trim Designs



NESC



ATESC



RLESC

Trim Selection



PULL DESIGN

9800 NL
IC9800NL
ICSC9800NL

FOR RIM DEVICES ONLY

Outside by pull and key.
Key retracts latch bolt.
ANSI function – 03
Covers 161 cutout

KEYWAY

6 pin solid brass “C” keyway
Rim Cylinder standard.

FINISHES

Architectural plated finishes.



9800 DTP

Outside by pull only.
Pull when dogged.
ANSI function – 02
Covers 161 cutout.



9800 EOP

Outside by plate only.
ANSI function – 10
Covers 161 cutout

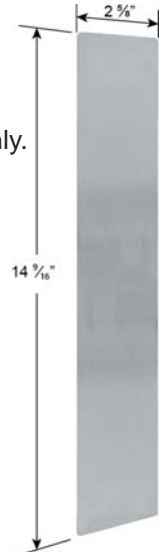

THUMBPIECE TRIM (OPERATES ON RIM & VERTICAL ROD DEVICES)

98TP00 or
IC98TP00
ICSC98TP00

ENTRANCE

Key locks or unlocks thumbpiece.
(Operates as classroom function)
ANSI Function – 63

98TP05 or
IC98TP05
ICSC98TP05

STOREROOM

Key unlocks thumbpiece, thumbpiece retracts
latch bolt, otherwise always locked. ANSI
Function-04

98TP30

PASSAGE

Trim always operable and free.
ANSI Function – 62

98TP40

DUMMY

Dummy trim. Includes blank Mortise dummy
cylinder. One sided.
ANSI function – 10

KEYED



DUMMY



KEYWAY: 6 pin solid brass “C” keyway Mortise Cylinder standard. Optional: Schlage E, Schlage C-K, Russwin D1-2-3-4, Corbin 59/60, Sargent LA-LB-LC, Falcon/Weiser E, Arrow A, Yale 8, Yale GA and Kwikset. Can also accept Medeco, Assa and Kaba High Security Cylinders.

(IC) INTERCHANGEABLE CORE

Interchangeable Core locks will accept compatible 6 or 7 pin cores with BEST, FALCON and ARROW.

(ICSC) INTERCHANGEABLE CORE

Indicates function available with Schlage Full size format Interchangeable Core.

FINISHES

Architectural plated finishes.

Electrified Lever Trim



GRADE 1 Rim Type Exit Device

Cal-Royal's electrified lever trim provides remote locking and unlocking capabilities while incorporating the patented clutch trim design. The 24V DC solenoid can be energized from a distant controller, thus allowing access control of the opening.

The control of stairwells in high-rise buildings is a common application for this trim, where electric pullback of the exit device's latch bolt is cost prohibitive or not required. This is especially practical in applications where fire/life safety codes require a "fail-safe" condition which is not an option with electrified latch pullback devices. Because the current draw is quite low there is no need for a more expensive power supply to provide the surge current.

Features

- Continuous duty solenoids used to insure trouble-free operation
- Internally mounted solenoid to ease installation (no special door prep required)
- No hassle 3-Year Warranty

Options

- Available Fail Safe (electrically locked) or Fail Secure (Electrically Unlocked)
- Voltage options – 12V or 24V (AC/DC)
- Request to Enter Switch (REE) available
- CRU2 – Current Reduction Unit to improve solenoid life in "continuously on" applications

Specifications

Solenoid.....Continuous Duty 24VDC

Operating Voltage....12 or 24VAC/DC + OR – 10% (must specify 12 or 24 volts when ordering)

Amperage.....260mA@12V / 160mA@24V

Coil Resistance.....12V=49Ω / 24V=159Ω

To order, Specify:

OPTIONS: FAIL SAFE (FS)
FAIL SECURE (FSE)

ITEM#	DESCRIPTION
FS12 ESC98	FS12 FAIL-SAFE OPTION 12V AC/DC
FS24 ESC98	FS24 FAIL-SAFE OPTION 24V AC/DC
FSE12 ESC98	FSE12 FAIL-SECURE OPTION 12V AC/DC
FSE24 ESC98	FSE24 FAIL-SECURE OPTION 24V AC/DC

Lever Trim Designs



NESC



ATESC



RLESC

TO ORDER other design insert "AT" or "RL" before "ESC"
e.g. ATESC98 for ESC98 in AT design or RLESC98 for ESC98 in RL design