

Installation

S19-120HFP

Frost-Proof Drench Shower

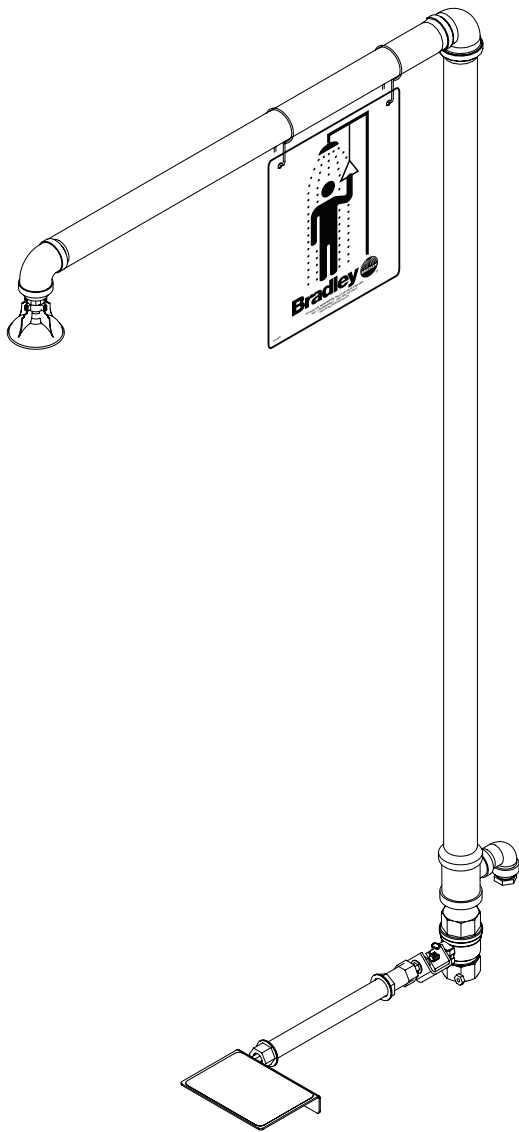

Table of Contents

Safety Information	2
Installation Instructions	3
Assembly of Components	4
Parts List	4



Read the instructions in this manual before beginning installation. Save these instructions and refer to them for inspection, maintenance and troubleshooting information.

For questions regarding the operation, installation or maintenance of this product, visit bradleycorp.com or call 800.BRADLEY (800.272.3539).

Product warranties and parts information may also be found under “Products” on our website at bradleycorp.com.



Safety Information

To ensure proper operation:

Installation

This fixture has been designed and 3rd party tested to meet ANSI/ISEA Z358.1. The system must be tested periodically to be sure it is functioning properly to meet the standard. Please refer to the ANSI/ISEA Z358.1 standard on testing requirements.

The installation, maintenance and location of all safety drench showers, eye and eye/face washes must comply with the requirements of ANSI/ISEA Z358.1. Workers who may come in contact with potentially hazardous materials should be trained regarding the location and proper operation of emergency equipment per ANSI/ISEA Z358.1.

ANSI/ISEA Z358.1 requires this unit to be used with a clean, potable, uninterrupted supply of tepid water. Bradley plumbed emergency fixtures require a minimum of 30 psi flowing pressure in order to function as designed and meet the ANSI/ISEA Z358.1 standard.

Before installation make sure that this equipment will meet the requirements of the potential hazardous contaminants in your location.

Installation of this system must be completed by a qualified plumber in compliance with all national and local codes. Compliance and conformity to drain requirements and other local codes and ordinances is the responsibility of the installer.

Weekly Inspections

To ensure all emergency shower and eye/face wash fixtures are ready to be used when needed, regular checks and maintenance must be conducted. Weekly inspections must be conducted on all safety equipment to make sure a suitable flushing fluid supply is present and to make sure the equipment is in good operating condition.

Water Temperature

ANSI/ISEA Z358.1 requires tepid water. Suitable range is 60°F to 100°F (16°C to 38°C). Personal injury is possible outside this temperature range.

Installation

Supplies Required:

- Teflon tape and pipe sealant
- Miscellaneous piping (refer to dotted lines)
- Piping to 1" NPT water supply inlet and 1/4" NPT female weep connection
- Adequate supply pipe supports
- Minimum 4" drain to accommodate 30 gallons per minute discharge for shower waste
- OPTIONAL: sign-mounting hardware
- Piping, 1" NPT between valve and showerhead

Step 1: Assemble components

1. Flush the water supply lines before beginning installation.
2. Assemble the components as shown on page 4.
 - Apply pipe sealant to all male-threaded pipe joints.
 - Use a strap wrench around pipes when tightening to prevent marring.
 - Bottom edge of showerhead should be 7'-0" (2134 mm) from the floor.

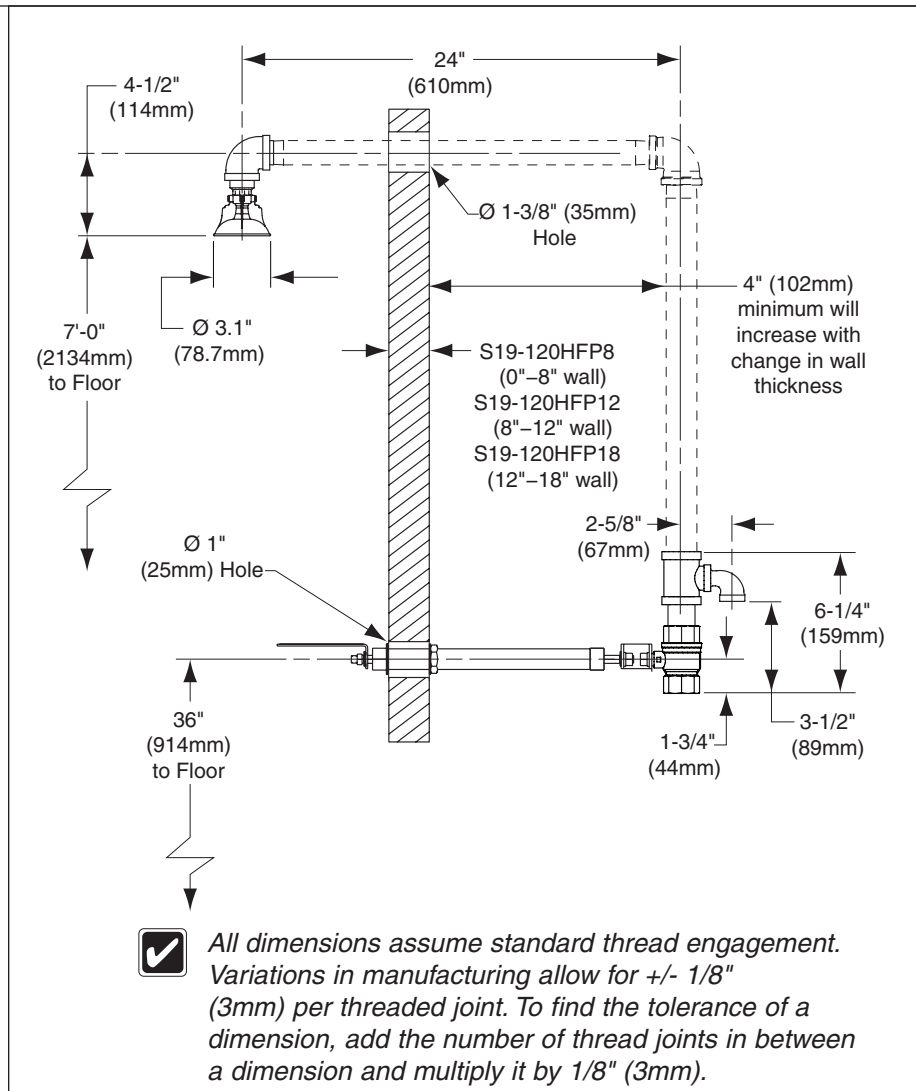

Step 2: Install operating stem support sleeve



This unit has been designed to accommodate varying wall thicknesses. When installing the operating stem support sleeve it will be necessary to cut off one or both ends of the sleeve so that 5/8" of threaded pipe protrudes from both sides of the wall.

1. Drill a 1-3/8" diameter hole in the wall 36" up from the ground floor for the valve operating stem.
2. Assemble the valve stem as shown on page 4 and connect the stem to the assembly through the hole in the wall.
3. Mark and drill a 1-3/8" diameter hole for the shower pipe.
4. Assemble the rest of the unit as shown on page 3.

Step 3: Connect water supply



Do not rely on Bradley's Drench Shower to support supply piping.

1. Connect water supply piping to the 1" NPT inlet (piping supplied by installer). Provide adequate supports (supplied by installer) for supply pipe using pipe hangers or other means.
2. Connect drain piping (supplied by installer) to the 1/4" NPT female weep connection.
3. Hang the safety sign from the unit with the curtain hooks provided (or mount it to the wall using sign-mounting hardware by installer).
4. Flush the supply lines after installation is complete. Test the unit for leaks and adequate water flow.

Assembly of Components

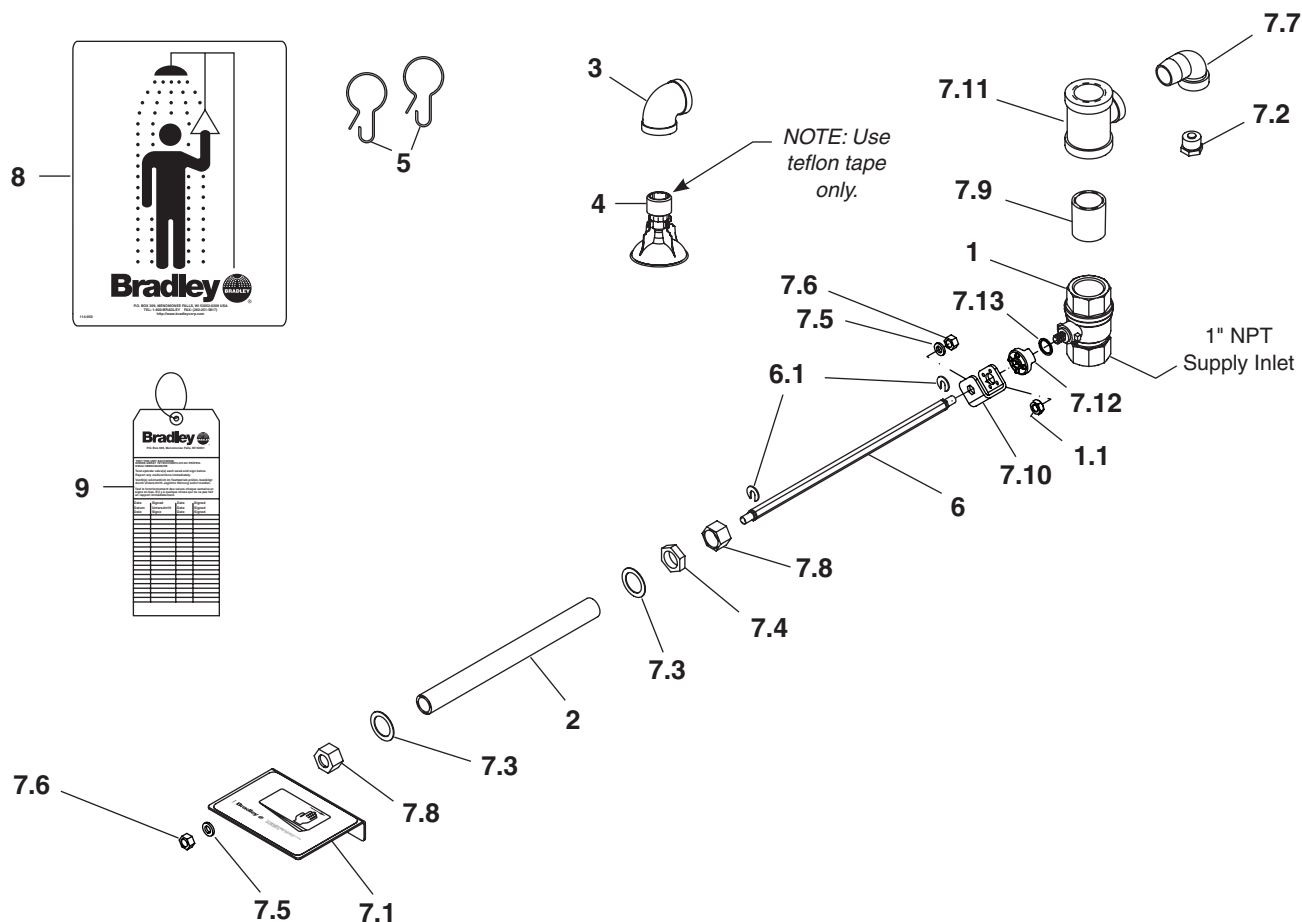

Parts List

Item	Part No.	Qty.	Description
1	S27-278	1	Stay-Open Ball Valve 1" NPT w/ Nut
1.1	110-214	1	Nut only
2	113-006NN	1	Pipe 1/2" NPT (0"–8")
	113-006NR	1	Pipe 1/2" NPT (8"–12")
	113-006NU	1	Pipe 1/2" NPT (12"–18")
3	169-847	1	90° Elbow 1" NPT
4	S24-188	1	Plastic Showerhead Assembly
5	151-001	2	Curtain Hook
6	S21-067	1	(0"–8") Operating Stem
	S21-067A	1	(8"–12") Operating Stem
	S21-067B	1	(12"–18") Operating Stem
6.1	132-042	2	Retaining Ring
7	S45-458	1	HFP Fittings
7.1	S08-711	1	Handle Assembly

Item	Part No.	Qty.	Description
7.2	S29-068	1	Weep Valve Assembly
7.3	124-001CB	2	Washer
7.4	110-115	1	Nut
7.5	142-002BK	2	Lockwasher
7.6	161-036	2	Hex Nut
7.7	169-025	1	90° Street Elbow 1/2" NPT
7.8	110-191	2	Connector Nut
7.9	113-006LN	1	Pipe
7.10	128-200	1	Handle
7.11	169-840	1	Tee, Reducing
7.12	153-489	1	Adapter
7.13	124-048	1	Washer
8	114-051	1	Safety Sign
9	204-421	1	Emergency Inspection Tag